

7000 and 8000 Room Controllers

VC3000 Relay Pack Specification Sheet

Line Voltage Switching Relay Pack for use with Line Voltage Fan Coil Unit (FCU) Room Controllers

The VC3000 is a relay pack for line-voltage fan coil units. The device is used with VTR73nn/VTR8350 and SER73nn/SER8350 Room Controllers as a two-component retrofit option.

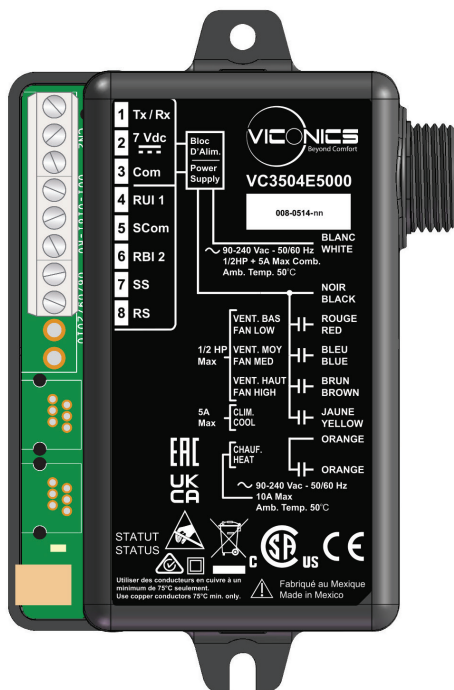

NOTICE

IMPORTANT NOTICE RELATED TO PRODUCT PART NUMBERS

For the latest model and part numbers, please refer to "8000 and 7000 Room Controllers Catalog", which can be found on <http://www.viconics.com> and <https://ecobuilding.schneider-electric.com>.

This document contains information on active and retired products. The latter are no longer sold by Viconics Technologies, Schneider Electric, or its partners.

For additional information on 7000 Room Controllers and a list of replacement part numbers, please visit <http://www.viconics.com>. You can also refer to the "7000 Series Room Controllers and Historical Offer Product Withdrawal Process (PWP) Project Product Announcement" (PA-00723) for a list of replacement part numbers, which can also be found on <https://ecobuilding.schneider-electric.com>.

Failure to follow these instructions can result in confusion or order delays.

VC3000 Relay Pack Features

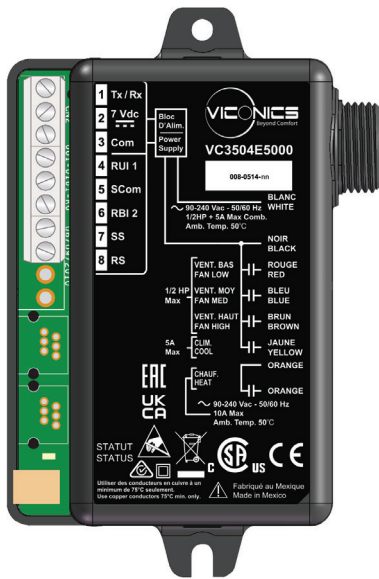

A compact and easy to install relay pack for line-voltage fan coil units to be used in combination with room controllers.

Introduction

The VC3000 relay pack is part of a two component retrofit option for line-voltage fan coil units. The relay pack must be combined with either VTR73nn/SER73nn or VTR8350/SER8350 room controllers.

The VC3000 relay pack features an onboard universal voltage power supply and line-voltage relays which directly drive fractional horsepower fan motors and valves. This eliminates the need to install and wire costly pilot relays and transformers.

No previous building automation training is required for the installation and commissioning process.

Existing line voltage wiring between the fan coil unit and temperature controller can be reused further minimizing overall labor and installation costs.

VC3000 Product Highlights

- Extremely compact design
- Line powered from 90 to 240 VAC 50-60 Hz
- Wire-leads for line-voltage connections
- Direct line switching of fan speed and valves
- Directly switches single phase electric resistive heater up to 10 Amps
- Dedicated supply air sensor for monitoring (model dependent)
- Dedicated return air sensor for control (model dependent)
- Two extra monitoring binary inputs (model dependent)
- Extra SSR output for low cost electric heat modulation (model dependent)



AT A GLANCE

- Compact design
- Models for 2-pipe and 4-pipe FCU
- Up to 3 speed fan control
- Up to 4 FCU remote inputs
- Up to 5 FCU outputs including heat, cool, fan and modulating pulsed reheat

VC3000 Relay Pack Applications and Specifications

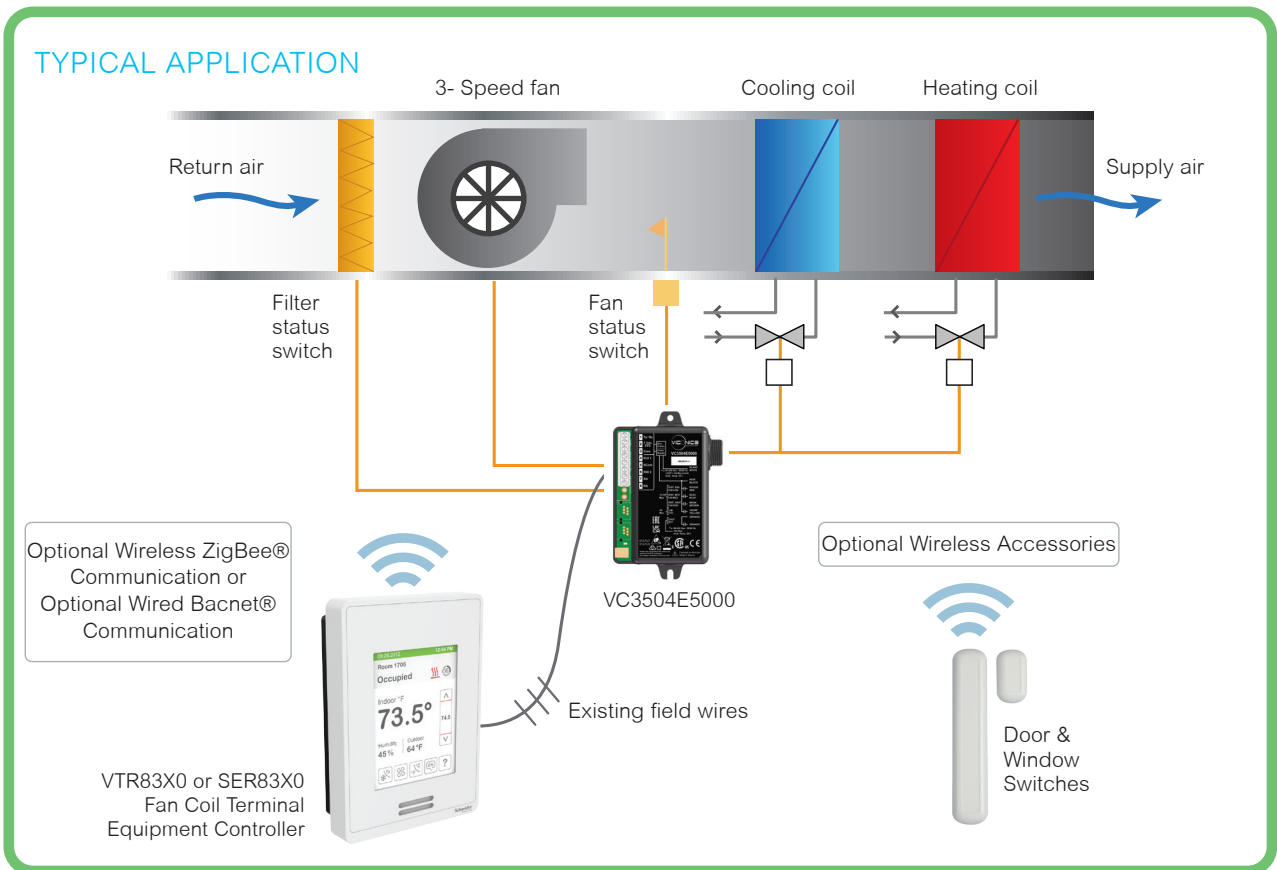

Specifications

VC3000

Dimensions

Height: 12cm/4.72in

Width: 8.6cm/3.38in

Depth: 2.5cm/1in

Power Requirements

90-240 Vac universal, 50/60Hz

Operating Conditions

0 °C - 50 °C (32 °F - 122 °F)

0% - 95% R.H. non-condensing

Storage Conditions

-30 °C - 50 °C (-22 °F - 122 °F)

0% - 95% R.H. non-condensing

Temperature Sensor

Local 10 K NTC type 2 thermistor

Temperature Sensor Resolution

± 0.1 °C (± 0.2 °F)

Temperature Control Accuracy

± 0.5 °C (± 0.9 °F) @ 21 °C (70 °F)

typical calibrated

Humidity Sensor and Calibration

Single point calibrated bulk polymer type sensor

Humidity Sensor Precision

Reading range from 10-90 % R.H. non-condensing 10 to 20% precision: 10%

20% to 80% precision: 5%

80% to 90% precision: 10%

Humidity Sensor Stability

Less than 1.0 % yearly (typical drift)

Dehumidification Setpoint Range

30% - 95% R.H.

Occ, Stand-By and Unocc Cooling

Setpoint Range

12.0 - 37.5 °C (54 - 100 °F)

Occ, Stand-By and Unocc Heating

Setpoint Range

4.5 °C - 32 °C (40 °F - 90 °F)

Room and Outdoor Air Temperature

Display Range

-40 °C - 50 °C (-40 °F - 122 °F)

Proportional Band for Room Temperature control

Cooling & Heating: Default: 1.8°C (3.2°F)

Binary Inputs

Dry contact across terminal BI1,

BI2 and UI3 to Scorn

Wire Gauge

14 gauge maximum, 22 gauge recommended

Fan Line Voltage Contact Electrical Ratings

Brown, Blue, Red wires 1/2 HP or 10A maximum.

Approximate Shipping Weight

0.34 kg (0.75 lb)

Main Heat Voltage Electrical Ratings

Orange wire, 10A maximum

Cool Line Voltage Electrical Ratings

Yellow wire, 5A maximum

Output Ratings

Fan: Brown, Blue, Red wires 1/2 HP or 10A at 240 Vac maximum.

Safety Standards All Models

IEC 60730-2-9

IEC 60730-1

CAN/CSA E60730-2-9

CAN/CSA E60730-1

UL 60730-2-9

UL 60730-1

EMC Standards All Models

EMC Directive 2014/30/EU

FCC Rules and Regulations CFR 47:

Part 15, Subpart B, Class A – EMC Radiated and Conducted Emissions for Commercial User

ETSI EN 301 489-1 (for wireless models)

ICES-003

Radio Standards (Wireless Models)

RTTE Directive 2014/53/EU

EN 301 328

RSS 210

THIS DEVICE COMPLIES WITH PART 15 OF THE FCC RULES. OPERATION IS SUBJECT TO THE FOLLOWING TWO CONDITIONS: (1) THIS DEVICE MAY NOT CAUSE HARMFUL INTERFERENCE, AND (2) THIS DEVICE MUST ACCEPT ANY INTERFERENCE RECEIVED, INCLUDING INTERFERENCE THAT MAY CAUSE UNDESIRED OPERATION.



Please check with your local government for instruction on disposal of these products.

VC3000 Relay Pack

Dimensions

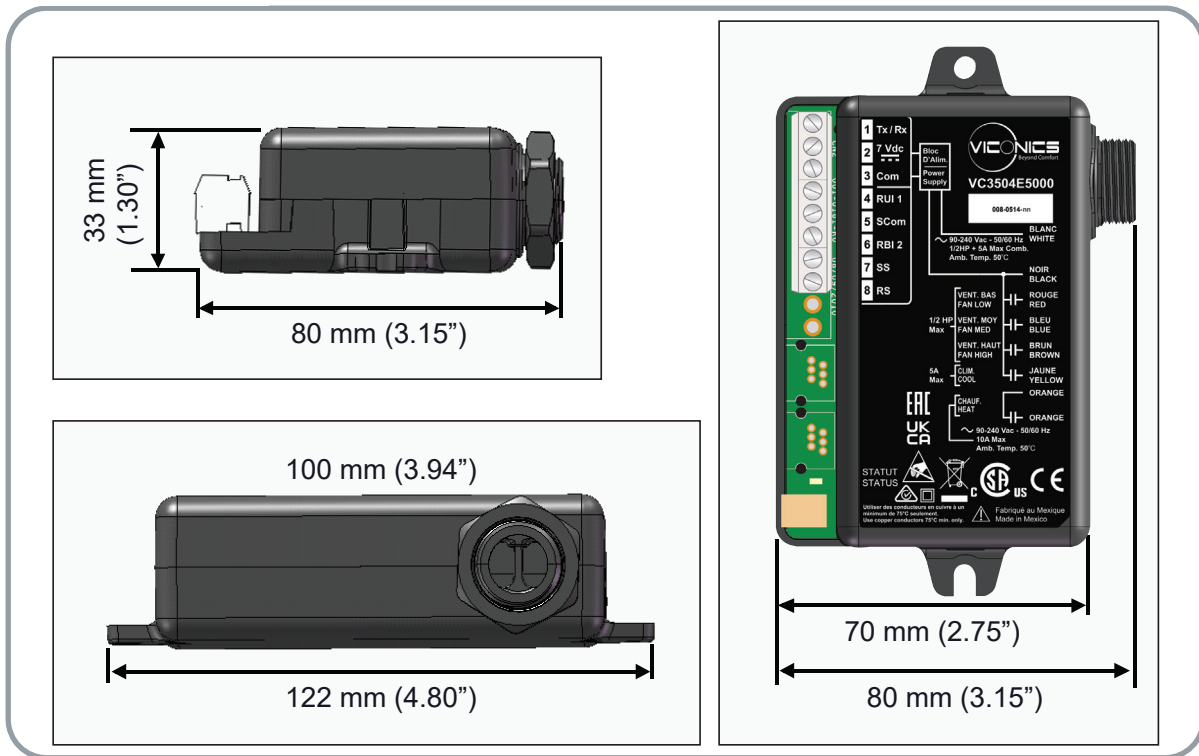

Ordering information

Part numbers	VC3500E5000	VC3504E5000	VC3514E5000 (with occupancy output)	VC3400E5000	VC3404E5000	VC3300E5000 (slave fan unit)
Applications	<ul style="list-style-type: none"> 2 pipes 2 pipes with reheat 4 pipes 	<ul style="list-style-type: none"> 2 pipes 2 pipes with reheat 4 pipes 	<ul style="list-style-type: none"> 2 pipes 2 pipes with reheat 4 pipes 	<ul style="list-style-type: none"> 2 pipes 2 pipes with modulating pulsed reheat 	<ul style="list-style-type: none"> 2 pipes 2 pipes with modulating pulsed reheat 	Slave fan control only
Fan control	Up to 3 speed	Up to 3 speed	Up to 3 speed	Up to 3 speed	Up to 3 speed	Up to 3 speed
Monitoring inputs	None	4 FCU remote inputs	4 FCU remote inputs	None	4 FCU remote inputs	None
Control types	On-Off line switched valve output control <ul style="list-style-type: none"> 1 heat / cool output 1 cool output 3 fan outputs 	On-Off line switched valve output control <ul style="list-style-type: none"> 1 heat / cool output 1 cool output 3 fan outputs 	On-Off line switched valve output control <ul style="list-style-type: none"> 1 heat / cool output 1 cool output 3 fan outputs Occupancy output (7VDC) 	On-Off line switched valve output control <ul style="list-style-type: none"> 1 heat / cool output 1 Modulating pulsed Vdc output for SSR electric reheat control 3 fan outputs 	On-Off line switched valve output control <ul style="list-style-type: none"> 1 heat / cool output 1 Modulating pulsed Vdc output for SSR electric reheat control 3 fan outputs 	Fan control only <ul style="list-style-type: none"> 3 fan outputs

All brand names, trademarks and registered trademarks are the property of their respective owners. Information contained within this document is subject to change without notice.