

1

2

3

4

A

A

**Schneider**  
Electric

TeSys LC1D40/50/65/80/95..C 交流接触器  
TeSys LC1D40/50/65/80/95..C AC Contactor

产品合格证  
Product certificate

本产品经检验，符合标准IEC60947/GB/T14048/GB21518  
准予出厂。

On inspection, this product is in accordance with standard  
IEC60947/GB/T14048/GB21518 and permitted to leave the  
factory.

上海施耐德工业控制有限公司  
Schneider Shanghai Industrial Control Co., Ltd

上海市普陀区绥德路629路，邮编：200331  
No. 629, Suide Road, Putuo District, Shanghai 200331

**Schneider Electric Industries SAS**  
35, rue Joseph Monier  
CS 30323  
F - 92500 Rueil Malmaison Cedex  
www.se.com

**Schneider Electric Limited**  
Stafford Park 5  
Telford, TF3 3BL  
United Kingdom  
www.se.com/uk

**UK  
CA**

B

B

C

C

D

D

E

E

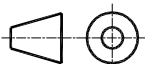

Scale:

Tolerancing Standard :

Units of measure :

mm

F

F

**Schneider**  
Electric

Instruction Sheet LC1D40~95...C  
产品合格证

Number:

CH01057

Revision:

12

Sheet:

1/11

The information is highly confidential and is the exclusive property of Schneider Electric copyright reserved. This drawing must not be used for any purpose other than that expressly permitted in writing by the owners and must not be disclosed or reproduced in any way without permission from the owners in writing. This drawing must be returned to the owners when the purpose has ceased.

State:

1

2

3

4

1

2

3

4

A

A

B

B

C

C

D

D

E

E

⚠ ⚠ 危险 / DANGER	
<p><b>电击、爆炸或电弧闪光危险</b></p> <ul style="list-style-type: none"> <li>在此电力设备上工作时,请先切断所有电源。</li> <li>请勿用手操作接触器。</li> <li>请勿去掉接触器的侧板。</li> </ul> <p><b>不遵循上述说明将导致人员伤亡。</b></p>	<p><b>HAZARD OF ELECTRIC SHOCK, EXPLOSION OR ARC FLASH</b></p> <ul style="list-style-type: none"> <li>Disconnect all power before servicing equipment.</li> <li>Do not operate the contactor manually.</li> <li>Do not remove the contactor's side panels.</li> </ul> <p><b>Failure to follow these instructions will result in death or serious injury.</b></p>

⚠ 警告 / WARNING	
<p><b>可能有引起火灾或触电的危险</b></p> <ul style="list-style-type: none"> <li>支路保护设备断开,可能表示故障电流已中断。</li> <li>如要降低起火或触电风险,应检查控制器的载流部件或其他部件,如有损坏,应予以更换。</li> </ul> <p><b>不遵循上述说明可能导致人员伤亡或设备损坏。</b></p>	<p><b>RISK OF FIRE OR ELECTRIC SHOCK</b></p> <ul style="list-style-type: none"> <li>The opening of the branch-circuit protective device may be an indication that a fault current has been interrupted.</li> <li>To reduce the risk of fire or electric shock, current-carrying parts and the other components of the controller should be examined and replaced if damaged.</li> </ul> <p><b>Failure to follow these instructions can result in death, serious injury, or equipment damage.</b></p>

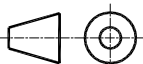

Scale:

Tolerancing Standard :

Units of measure :

mm

**Schneider**  
Electric

Instruction Sheet LC1D40~95...C

产品合格证

Number:

CH01057

Revision:

12

Sheet:

2/11

The information is highly confidential and is the exclusive property of Schneider Electric copyright reserved. This drawing must not be used for any purpose other than that expressly permitted in writing by the owners and must not be disclosed or reproduced in any way without permission from the owners in writing. This drawing must be returned to the owners when the purpose has ceased.

State:

1

2

3

4

F

F

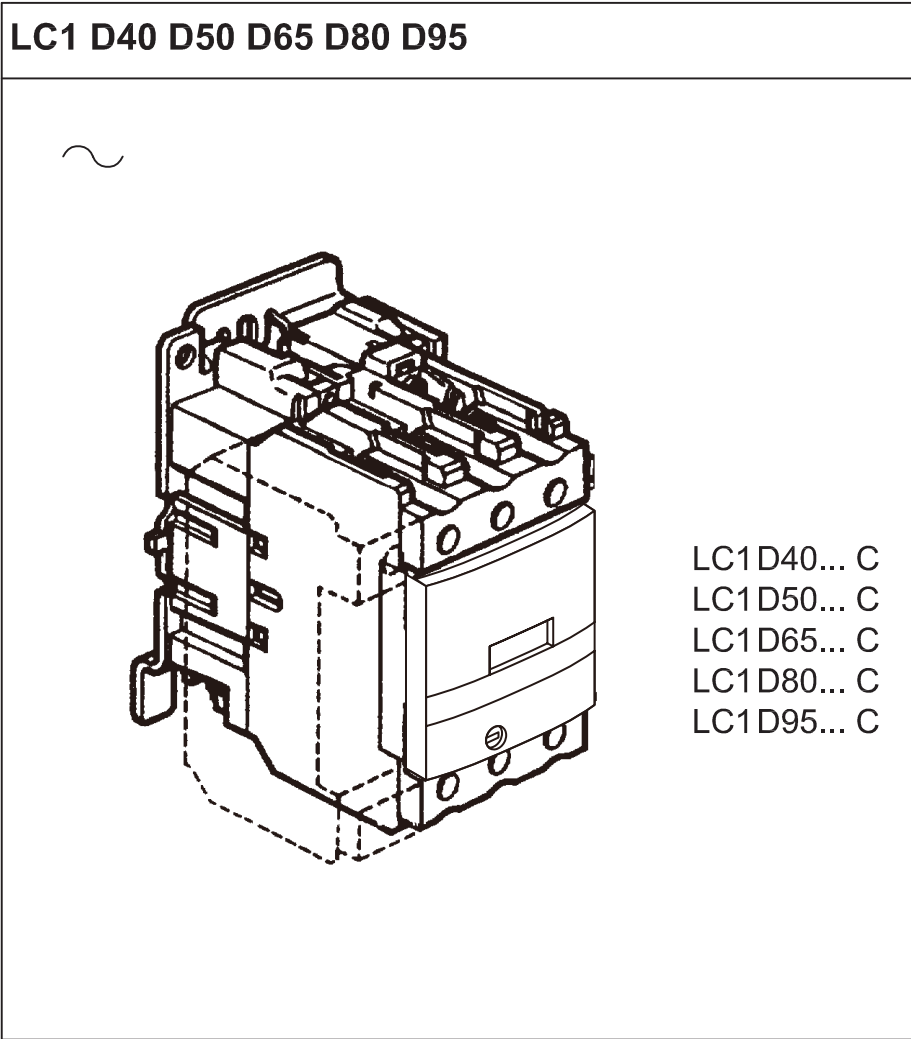

以下型号产品符合能效要求, 产品的吸持功率和能效等级分别如下:  
 The following products meet the Energy Efficiency requirements. The power consumption and the Energy Efficiency grades are:

产品型号 (Product Type)	LC1D40..C	LC1D50..C	LC1D65..C	LC1D80..C	LC1D95..C
最大吸持功率低于(VA) (Maximum Power consumption lower than)	36.6	36.6	36.6	36.6	36.6
能效等级 (Energy efficiency grade)	2	2	2	2	2

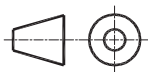

Scale:

Tolerancing Standard :

Units of measure :  
mm



Instruction Sheet LC1D40~95...C  
 产品合格证

Number:

CH01057

Revision:  
12

Sheet:  
3/11

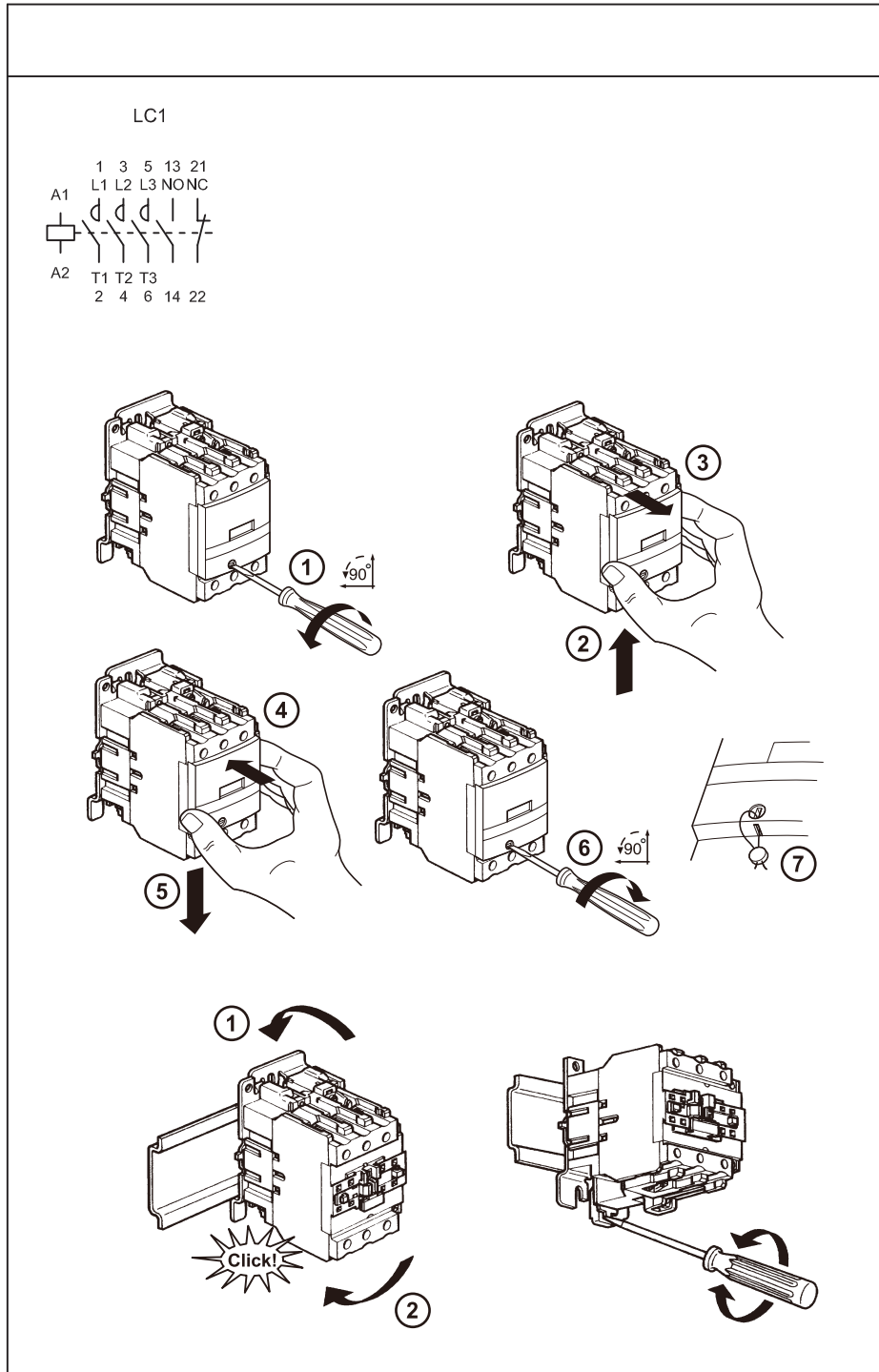

2

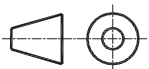

Scale:

Tolerancing Standard :

Units of measure :  
mm



Instruction Sheet LC1D40~95...C  
产品合格证

Number:

CH01057

Revision:  
11

Sheet:  
4/11

The information is highly confidential and is the exclusive property of Schneider Electric copyright reserved. This drawing must not be used for any purpose other than that expressly permitted in writing by the owners and must not be disclosed or reproduced in any way without permission from the owners in writing. This drawing must be returned to the owners when the purpose has ceased.

State:

# 辅助模块 Aux. contact block

1 "F"	LADN10/ LA1DN10
1 "O"	LADN01/ LA1DN01
1 "F" + 1 "O"	LADN11/ LA1DN11
2 "F"	LADN20/ LA1DN20
2 "O"	LADN02/ LA1DN02
2 "F" + 2 "O"	LADN22/ LA1DN22
1 "F" + 3 "O"	LADN13/ LA1DN13
4 "F"	LADN40/ LA1DN40
4 "O"	LADN04/ LA1DN04
3 "F" + 1 "O"	LADN31/ LA1DN31
2 "F" + 2 "O"	LADC22/ LA1DC22
2 "F"	LADX20/ LA1DX20(1)
2 "F" + 2 "F"	LADZ40/ LA1DZ40(1)
1 "F" + 1 "O" + 2 "F"	LADZ31/ LA1DZ31(1)
2 "F"	LADY20/ LA1DY20(1)
0.1 ~ 3 s	LADT0 / LA2DT0
0.1 ~ 30 s	LADT2 / LA2DT2
1 ~ 30 s	LADS2 / LA2DS2
10 ~ 180 s	LADT4 / LA2DT4
0.1 ~ 3 s	LADR0 / LA3DR0
0.1 ~ 30 s	LADR2 / LA3DR2
10 ~ 180 s	LADR4 / LA3DR4

⊗  
1 "F" + 1 "O" LAD8N11/ LA8DN11 (2)  
2 "F" LAD8N20/ LA8DN20 (2)

(1) p.7  
(2) p.6

LADN● / LA1DN●  
LADT● / LA2DT●  
LADR● / LA3DR●

LADN<sup>01</sup> / LA1DN<sup>01</sup><sub>10</sub>

LADN● / LA1DN●  
LADT● / LA2DT●  
LADS● / LA2DS●  
LADR● / LA3DR●

LADN<sup>01</sup> / LA1DN<sup>01</sup><sub>10</sub>



Scale:

Tolerancing Standard :

Units of measure

mm



## Instruction Sheet LC1D40~95...C 产品合格证

Number:

CH01057

Revision:

12

She

5/11

# 尺寸 Size

LC1D40/50/65/80/95

LC2D40/50/65/80/95

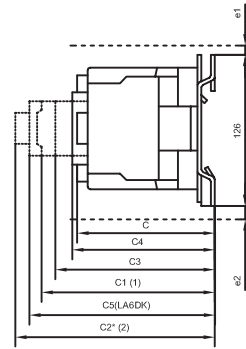
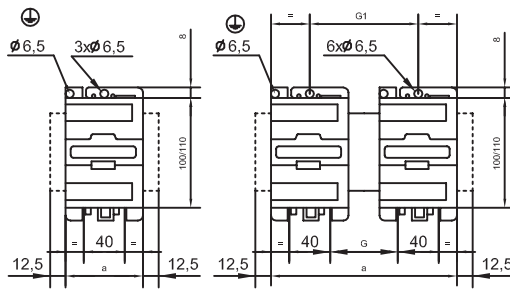

LA8DN

LAD8N

3P

(mm) a	~ ---
LC1D40...65	75
LC1D80...95	85
LC2D40...65	165
LC2D80...95	182

3P

(mm)	e1	C3	e2	G	G1
LC2D40...65	5	142	11	50	90
LC2D80...95	13	158	20	58	96

(mm)	3P				
	C	C4	C1	C5	C2*
~ LC•D40...65	114	146	116	157	165
~ LC•D80...95	125	153	127	165	176

(1): LADN LADC LA1D  
 (2): LADR LADT LADS LA2D LA3D  
 \* + 4 mm (LA9-D901)  
 (mm) 1 inch=25.4 mm

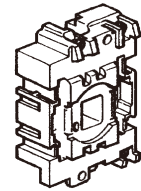
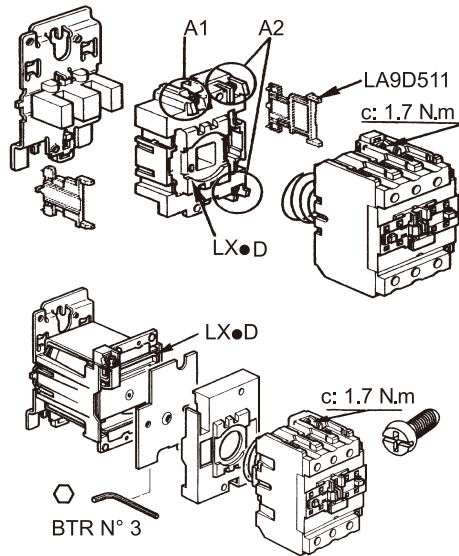

~ LX1

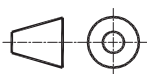

Scale:

Tolerancing Standard :

Units of measure

mm



Instruction Sheet LC1D40~95...C  
 产品合格证

Number:

CH01057

Revision:

12

She

6/11

State:

操作位置和连接导线 Operation position and connection cable

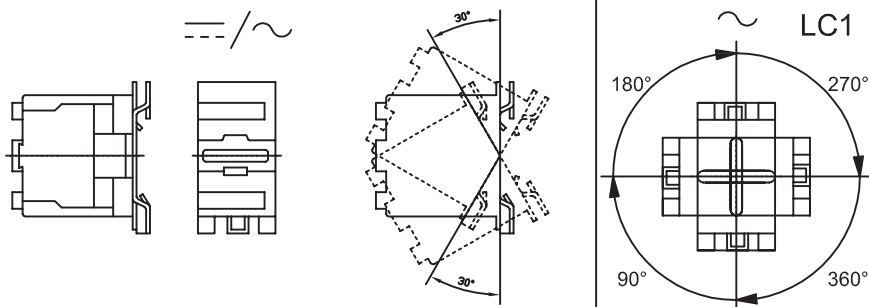

接线最小...最大  
Wiring Min...Max

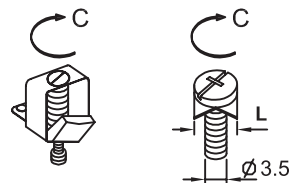

LC1 LC2										L			C Nm
		[mm <sup>2</sup> ]	[mm <sup>2</sup> ]	[mm <sup>2</sup> ]	[mm <sup>2</sup> ]	[mm <sup>2</sup> ]	[mm <sup>2</sup> ]	[mm]		[mm]	PH/PZ		
D40 D50 D65		1...2.5	1...2.5 +	1...4	1...4 +	1...4	1...4 +	8		7.5	Ø6	2	1.2
		2.5 : 25	2.5...10 + 2.5...10	2.5 : 25	2.5...16 + 2.5...16	2.5 : 25	2.5...16 + 2.5...16	16		-	Ø6 Ø8		5
D80 D95		1...2.5	1...2.5 +	1...4	1...4 +	1...4	1...4 +	8		7.5	Ø6	2	1.2
		4 : 50	4...16 + 4...16	4 : 50	4...25 + 4...25	4 : 50	6...25 + 6...25	17	4	-	Ø6 Ø8		12*
LX.D LA.D		1...2.5	1...2.5 +	1...4	1...4 +	1...4	1...4 +	8		7.5	Ø6	2	1.2

\* After installation due to creepage effect, it is recommended to recheck the torque periodically, especially for over 35 mm<sup>2</sup> rigid cable and double cables.

\* 安装完成后, 考虑到金属蠕变效应, 建议定期检查扭矩, 尤其是对于大于35 mm<sup>2</sup>的刚性电缆和双根导线, 更应如此。

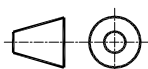

Scale:

Tolerancing Standard :

Units of measure

mm



Instruction Sheet LC1D40~95...C  
产品合格证

Number:

CH01057

Revision:

12

She

7/11

## 推荐的主回路端子类型 Recommended main pole terminal

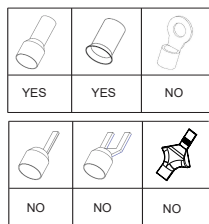

- 上述端子标记“NO”本产品不适用, 请严格按照施耐德推荐的端子类型接线。  
The above terminal mark "NO" is not applicable to this product.  
Please strictly follow the terminal type recommended by Schneider for wiring.

- 对于 LC1D80(C)-LC1D95(C) 接线端子的有效接触长度等于17mm。  
For LC1D80(C)-LC1D95(C), terminal conductive length of terminal should be 17mm.

- 带绝缘套端子接线时避免绝缘套被压到瓦片下。  
When wiring with insulated terminals, avoid the insulation sleeve being pressed under the tile.

- 对于小于等于10mm<sup>2</sup> 导线推荐使用局部与六角形压接, 对于大于等于16mm<sup>2</sup> 相关导线推荐使用六角形压接。  
For conductors' cross-sectional area ≤ 10mm<sup>2</sup>, indent and hexagonal crimping are recommended. For conductors' cross-sectional area ≥ 16mm<sup>2</sup>, hexagonal crimping is recommended to be used.

## 其他辅助模块 Other Aux. Contact Block

LAD8N11/LA8DN11

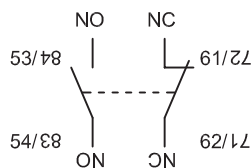

LAD8N20/LA8DN20

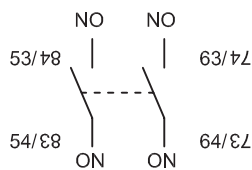

LC1/LC2

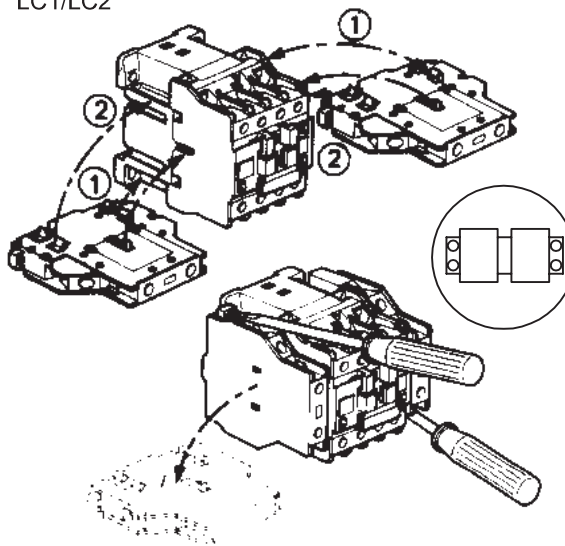

LC1/LC2	A1 A2	Un	LADN./LA1D. LADT./LA2D. LADR./LA3D. LA6DK.	LAD8N/LA8DN		
LC1D40~D95		0.8-1.1	●			
LC1D40~D95 LC2D40~D95		0.8-1.1	●			
		0.85-1.1	●	●	●	●
	50 Hz	0.8-1.1	●	●	●	●
	60 Hz	0.8-1.1	●	●	●	●

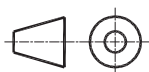

Scale:

Tolerancing Standard :

Units of measure :

mm



Instruction Sheet LC1D40~95...C  
产品合格证

Number:

CH01057

Revision:

12

Sheet:

8/11

### 其他辅助模块 Other Aux. Contact Block

- LA1DX/DY/DZ  
用于恶劣环境的辅助触头组  
This aux. block for foul environment.

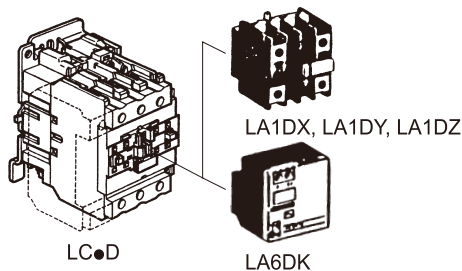

- LA6DK

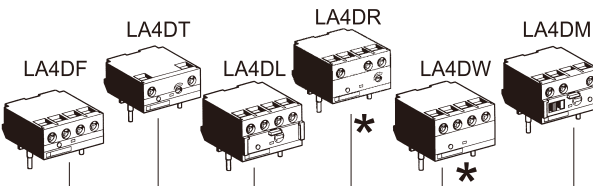
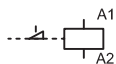

- LA4DF/DW/DL  
接口模块  
Connection block

- LA4DM  
自动-停止-手动控制模块  
Auto-stop-manual control block

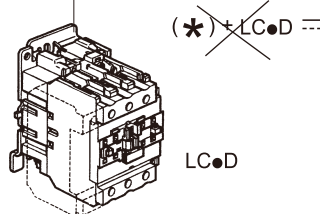

- LA4DT/DR  
延迟接通及断开计时器模块  
Time delay aux. contact block

- LA4DA/DE/DC/DB  
线圈抑制器模块  
Coil suppresser

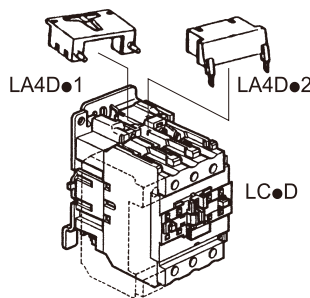

7

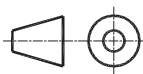

Scale:

Tolerancing Standard :

Units of measure :

mm



Instruction Sheet LC1D40~95...C  
产品合格证

Number:

CH01057

Revision:

12

Sheet:

9/11

1

2

3

4

A

A

B

B

C

C

D

D

E

E

钻孔模板

Drilling template

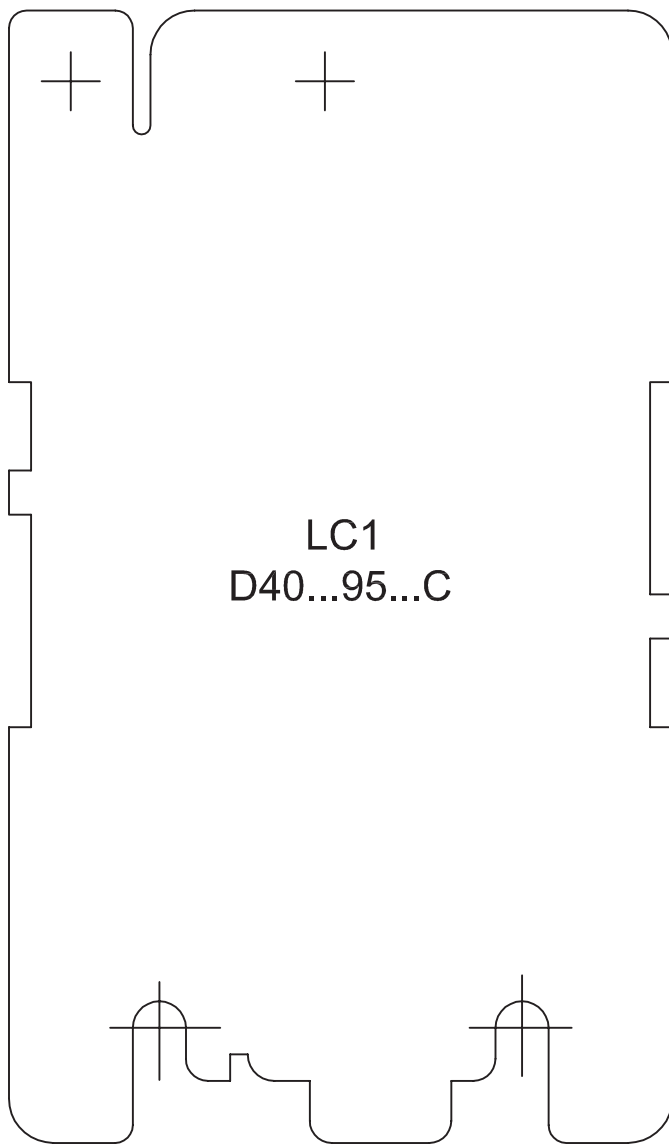

LC1  
D40...95...C

8

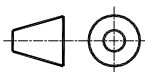

Scale:

Tolerancing Standard :

Units of measure :

mm

F

F



Instruction Sheet LC1D40~95...C  
产品合格证

Number:

CH01057

Revision:

12

Sheet:

10/11

The information is highly confidential and is the exclusive property of Schneider Electric copyright reserved. This drawing must not be used for any purpose other than that expressly permitted in writing by the owners and must not be disclosed or reproduced in any way without permission from the owners in writing. This drawing must be returned to the owners when the purpose has ceased.

State:

1

2

3

4

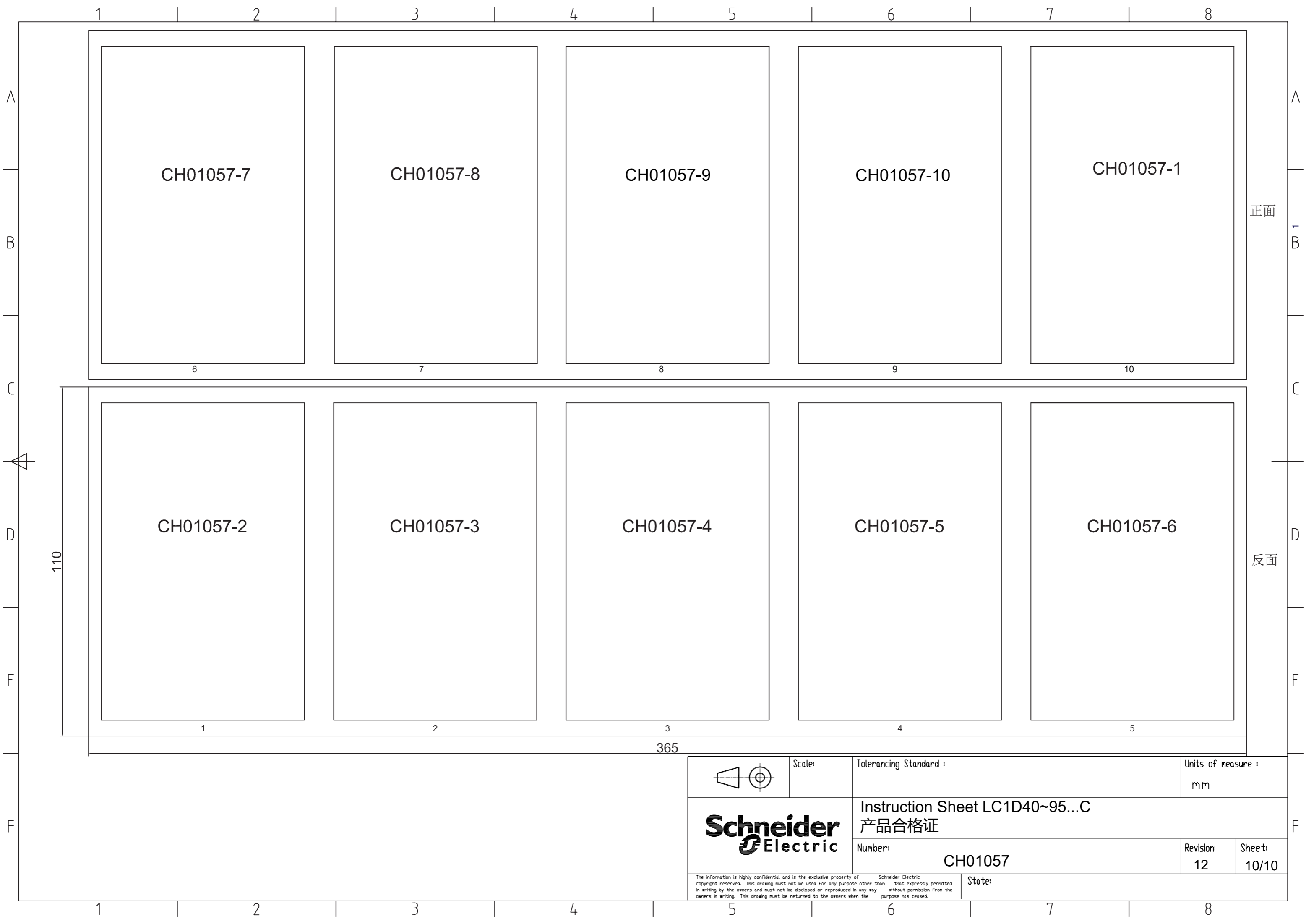

CH01057-7

CH01057-8

CH01057-9

CH01057-10

CH01057-1

CH01057-2

CH01057-3

CH01057-4

CH01057-5

CH01057-6

110

365

正面

反面

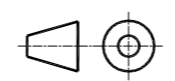

Scale:

Tolerancing Standard :

Units of measure :  
mm



Instruction Sheet LC1D40~95...C  
产品合格证

Number: CH01057

Revision: 12  
Sheet: 10/10

The information is highly confidential and is the exclusive property of Schneider Electric. Copyright reserved. This drawing must not be used for any purpose other than that expressly permitted in writing by the owners and must not be disclosed or reproduced in any way without permission from the owners in writing. This drawing must be returned to the owners when the purpose has ceased.

State: