

# Section 25

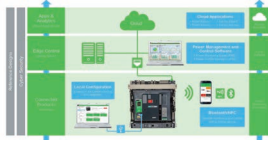

EcoStruxure™ Power



EcoStruxure™ Building

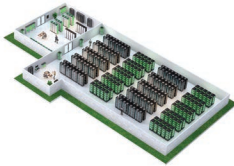

EcoStruxure™ IT

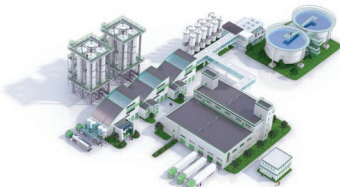

EcoStruxure™ Plant and Machine



EcoStruxure™ Grid

## EcoStruxure™ and Schneider Electric Services

Overview of EcoStruxure™	25-2
EcoStruxure™ Power	25-3
EcoStruxure™ Building	25-4
EcoStruxure™ IT	25-5
EcoStruxure™ Plant and Machine	25-6
EcoStruxure™ Grid	25-7
Schneider Electric Services	25-8

## EcoStruxure™: IoT-enabled Architecture and Platform

### What is EcoStruxure?

EcoStruxure is Schneider Electric's IoT-enabled, plug-and-play, open, interoperable architecture and platform, in Homes, Buildings, Data Centers, Infrastructure and Industries.

EcoStruxure delivers one architecture, serving four end markets (Building, Data Center, Industry, Infrastructure), with six domains of expertise: [1]

- EcoStruxure Power
- EcoStruxure Building
- EcoStruxure IT
- EcoStruxure Plant and Machine
- EcoStruxure Grid

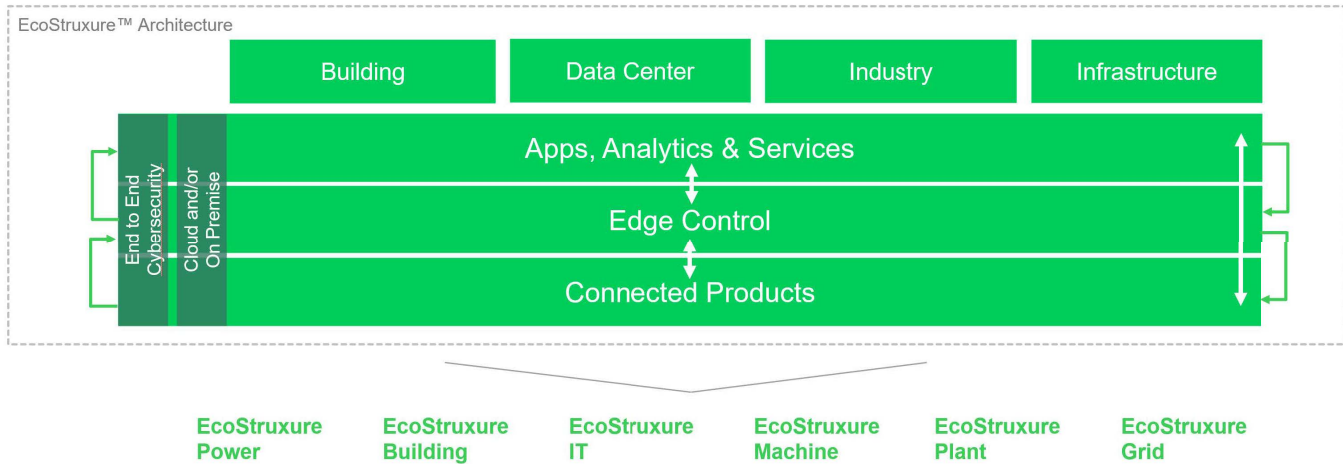

### Apps, Analytics, and Services [1]

Interoperability is imperative to supporting the diverse hardware and systems in building, data center, industry, and grid end markets. EcoStruxure enables a breadth of agnostic applications, analytics & services for seamless enterprise integration.

### Edge Control [1]

Mission-critical scenarios can be unpredictable, so control of devices at the edge of the IoT network is a must. This essential capability provides real-time solutions that enable local control at the edge, protecting safety and uptime.

### Connected Products [1]

The Internet of Things starts with the best things. Our IoT-enabled best-in-class connected products include breakers, drives, UPSs, relays, sensors, and more. Devices with embedded intelligence drive better decision-making throughout operations.

### What is EcoStruxure Platform?

At the heart of our IoT system architecture is the EcoStruxure Platform. Connecting everything in your enterprise from the shop floor to the top floor. Collecting critical data, from sensors to the cloud. Analyzing data to discover meaningful insights. Enabling you to act based on real-time information and business logic.

The EcoStruxure Platform is the foundational technology backbone on which Schneider Electric solutions are built and delivered.

Visit [EcoStruxure Platform](https://www.se.com/us) on [se.com/us](https://www.se.com/us)

[1] EcoStruxure™ is continually evolving and expanding. The printed Digest may not reflect all available connected products, apps, analytics, and services. Refer to [EcoStruxure™](https://www.se.com/us) on [se.com/us](https://www.se.com/us) for the latest information.

**EcoStruxure™ Power**

Schneider Electric's EcoStruxure Power offers advanced power system communication at every level of your operation. Connected products such as MasterPact MTZ circuit breakers are a key component of EcoStruxure Power, providing real-time operations data, smart analytics, and improved safety and security to your facility and processes. Welcome to the future of power distribution. [1]

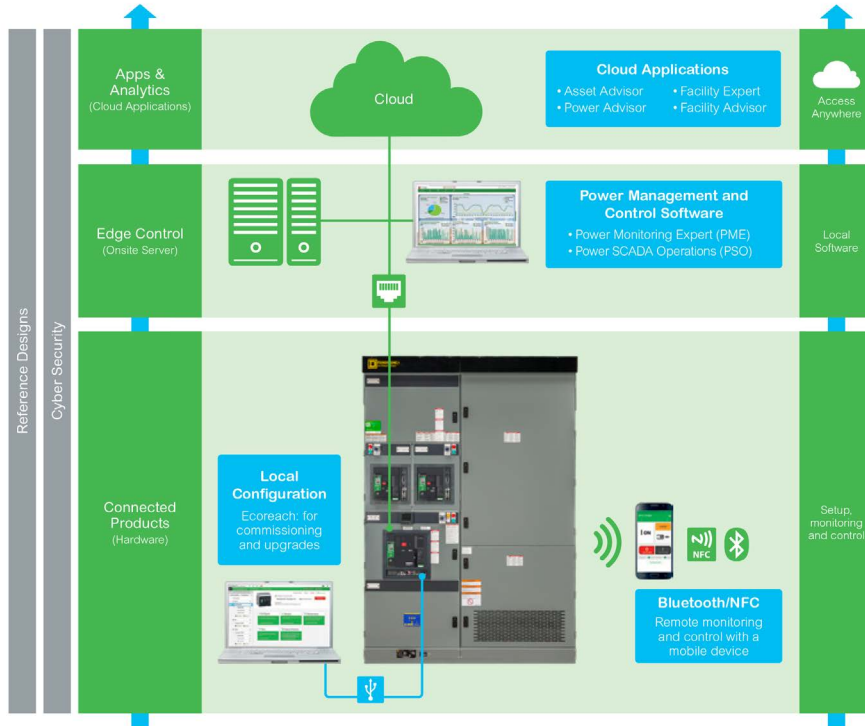

Visit [EcoStruxure Power](http://www.se.com/us) on [www.se.com/us](http://www.se.com/us) for the latest information.

**Apps, Analytics & Services [1]**

Get actionable predictive maintenance information that protects your customers, safeguard your reputation and minimizing financial impact.

- [EcoStruxure Asset Advisor](#)
- [EcoStruxure Power Advisor](#)
- [EcoStruxure Resource Advisor](#)

**Edge Control [1]**

Track equipment and maintenance activity to reduce downtime, energy use, and maintenance costs while improving site planning and revealing additional capacity.

- [EcoStruxure Power Monitoring Expert](#)
- [EcoStruxure Power Operation](#)
- [EcoStruxure Substation Operation](#)

**Connected Products [1]**

Monitor power distribution, anticipate needs, pinpoint concerns, and control assets remotely.

- [MasterPacT MTZ Circuit Breakers Connectivity](#)
- [PowerLogic Power and Energy Meters](#)
- [Enerlin'X Com'X Energy Servers and Data Loggers](#)
- [Smart Systems](#)
- [Galaxy VX UPS](#)
- [Premset MV Switchgear](#)

[1] EcoStruxure™ is continually evolving and expanding. The printed Digest may not reflect all available connected products, apps, analytics, and services. Refer to [EcoStruxure™](http://www.se.com/us) on [se.com/us](http://www.se.com/us) for the latest information.

## EcoStruxure™ Building

From design, through integration to commissioning, EcoStruxure™ Building brings best-in-class engineering efficiency to your building. Combined with our asset and energy performance services, we enable lifetime efficiency of your building ensuring productivity and comfort for occupants. [1]



Visit [EcoStruxure Building](https://se.com/us) on [se.com/us](https://se.com/us) for the latest information

### Apps, Analytics, and Services [1]

Gain actionable insights via apps, analytics and services based on best-in-class expertise, processes and predictive technology.

- [EcoStruxure Resource Advisor](#)
- [Digital Services for Buildings](#)
- [EcoStruxure Workplace Advisor](#)
- [Connected Services / Field Services](#)

### Edge Control [1]

Simplify integration between buildings and systems with EcoStruxure Building Management.

- [Building Management](#)

### Connected Products [1]

Build a solid foundation with connected devices ranging from valves actuators and controllers, to circuit breakers, sensors and meters.

- [MasterPacT MTZ Circuit Breakers Connectivity](#)
- [PowerLogic Power and Energy Meters](#)
- [Altivar Drives](#)
- [PowerPacT Circuit Breakers](#)
- [Smart Systems](#)
- [Uninterruptible Power Supply \(UPS\)](#)
- [SpaceLogic – Smart and Connected Devices](#)

[1] EcoStruxure™ is continually evolving and expanding. The printed Digest may not reflect all available connected products, apps, analytics, and services. Refer to [EcoStruxure™](https://se.com/us) on [se.com/us](https://se.com/us) for the latest information.

### EcoStruxure™ IT

In a connected world, it's now more important than ever to protect critical information and data. Ensure that your data center's physical infrastructure can adapt quickly to support both future demand driven by IoT and growth (in the cloud and at the edge) without ever compromising availability or operational efficiency. [1]

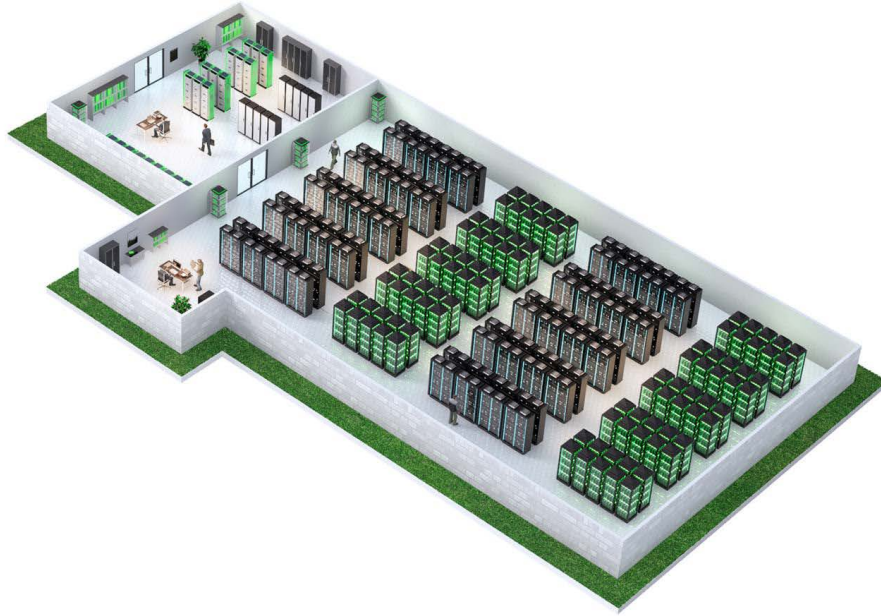

Visit [EcoStruxure IT](https://se.com/us) on [se.com/us](https://se.com/us) for the latest information

#### Apps, Analytics & Services [1]

Increasing resiliency and visibility through live sensor data, predictive analytics and smart alarming.

- [EcoStruxure IT Advisor](#)
- [EcoStruxure Asset Advisor](#)

#### Edge Control [1]

For real-time monitoring, incident management, analysis and asset utilization.

- [EcoStruxure IT Expert](#)

#### Connected Products [1]

Connecting the domains of IT, mechanical and power room for resiliency and efficiency.

- Visit [EcoStruxure IT](https://se.com/us) on [se.com/us](https://se.com/us) for the latest connected products.

[1] EcoStruxure™ is continually evolving and expanding. The printed Digest may not reflect all available connected products, apps, analytics, and services. Refer to [EcoStruxure™](https://se.com/us) on [se.com/us](https://se.com/us) for the latest information.



## EcoStruxure™ Plant and Machine

Schneider Electric is leading the digital transformation of industrial automation markets. Delivered through our EcoStruxure architecture, our IIoT technologies, including integrated software, are ready for smart manufacturing and can deliver new business opportunities for plants and machine builders — increasing profitability and productivity.

[1]

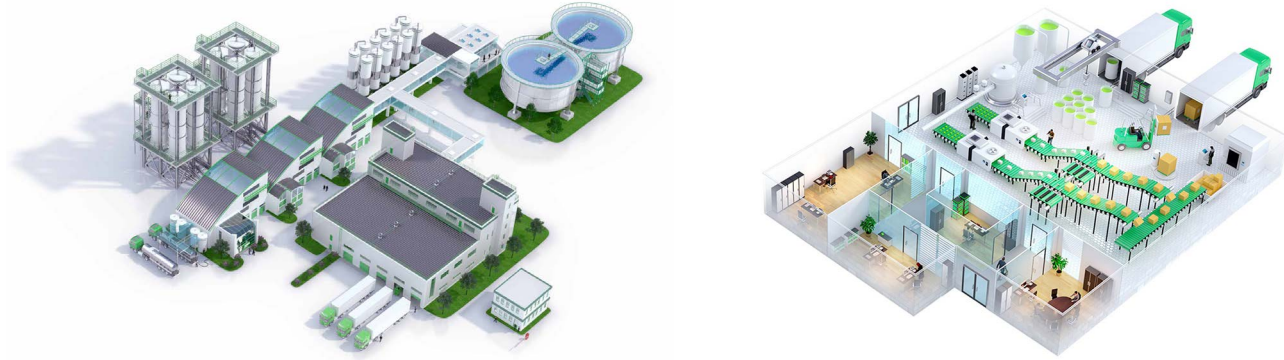

### Apps, Analytics & Software [1]

Our full portfolio of software, apps, and analytics offer tools and information in a format that is easily actionable to turn plant personnel into business decision makers, who can contribute easily to optimizing your system.

- Industrial Automation Software
- Aveva System Platform (formerly Wonderware)
- EcoStruxure Machine Advisor
- EcoStruxure Secure Connect Advisor
- EcoStruxure Augmented Operator Advisor
- EcoStruxure Machine Expert Software (Formerly SoMachine)
- EcoStruxure Control Advisor
- EcoStruxure Maintenance Advisor
- EcoStruxure Asset Advisor
- EcoStruxure Resource Advisor

### Edge Control [1]

Our connected control platforms provide better insight into operations, reduce time to market, reduce process energy consumption and improve productivity.

- Harmony Industrial PCs
- Modicon M580 PAC Controller
- EcoStruxure - Foxboro DCS
- EcoStruxure - Triconex Safety Instrumented System
- EcoStruxure Solutions for Machines
- Building Management Systems

### Connected Products [1]

Our connected products bring intelligence to your system, enabling your assets to provide advanced process data for smarter operations.

Visit [EcoStruxure Plant](#) and [EcoStruxure Machine](#) on [se.com/us](#) for the latest connected products.

[1] EcoStruxure™ is continually evolving and expanding. The printed Digest may not reflect all available connected products, apps, analytics, and services. Refer to [EcoStruxure™](#) on [se.com/us](#) for the latest information.

## EcoStruxure™ Grid

From seamless local production and integration at the grid edge, to bridging demand and supply, EcoStruxure™ Grid increases your grid's efficiency for sustainable networks. [1]



### Apps, Analytics, and Services [1]

Smart grid analytics for efficient operations, predictive maintenance and investment plans. A complete services portfolio - from field instruments to control room - to help optimize assets, people, equipment and plant, at every stage of your asset life cycle.

- EcoStruxure ADMS
- EcoStruxure ArcFM
- EcoStruxure Asset Advisor
- EcoStruxure Microgrid Advisor
- EcoStruxure Grid Metering Operation
- Field Services

### Edge Control [1]

Secure, reliable & efficient grid, substation & meter management.

- EcoStruxure Substation Operation
- EcoStruxure Microgrids
- EcoStruxure Grid Metering Operation

### Connected Products [1]

Remote control & monitoring insights on mobile tools for safer maintenance and operations.

Visit [EcoStruxure Grid se.com/us](https://www.se.com/us) for the latest connected products.

- PowerLogic
- EcoStruxure ADMS
- ArcFM Geographic Information Systems (GIS)
- EcoStruxure DERMS (Distributed Energy Resource Management System)

[1] EcoStruxure™ is continually evolving and expanding. The printed Digest may not reflect all available connected products, apps, analytics, and services. Refer to [EcoStruxure™](https://www.se.com/us) on [se.com/us](https://www.se.com/us) for the latest information.

## Decarbonizing and electrifying faster with Schneider Electric Services, your lifelong partner

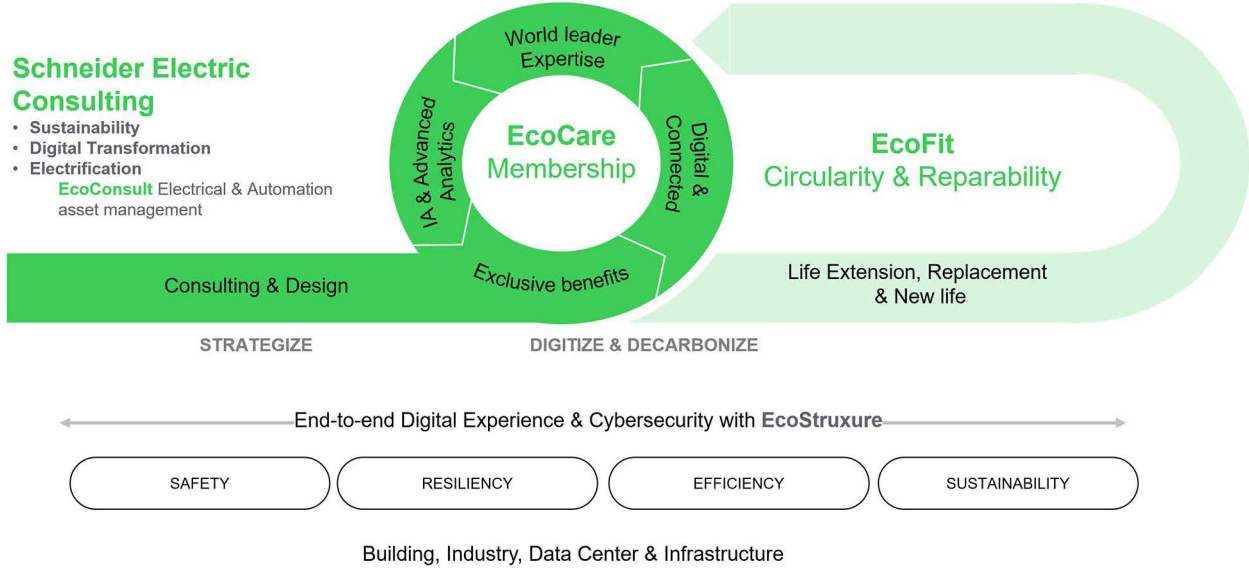

25 **ECOSTRUXURE™ AND SCHNEIDER ELECTRIC SERVICES**

**EcoConsult** services for electrical distribution and automation systems. Our consultants help you identify potential safety, compliance, and performance issues to reduce risk and improve reliability. We offer a complete set of solutions for studies, audits, and design that include digital twin technologies, short circuit, coordination, arc flash, power quality, NFPA compliance and more.

**EcoCare** services membership helps you achieve up to 75% less unplanned downtime, up to 40% less on-site activities, and planned downtime, and extend the lifetime of your equipment.<sup>[1]</sup> Access fast priority support, 24/7 monitoring and alarming, calendar-based preventive maintenance or condition-based, exclusive rates on all services, and more.

**EcoFit™** our unique approach to modernization and circularity services. Outdated equipment and installations waste energy, increase operating costs and put your business continuity at risk every day. You can solve these problems and modernize your equipment with EcoFit™. It enables high performance with digital technologies and supports your decarbonization journey.

[se.com/us/services](http://se.com/us/services)

[1] These percentages are non-contractual and are based on Schneider Electric's experience and expertise concerning the main root cause of downtime observed and for which Schneider Electric has developed solutions.