

# Product End of Life Instructions

## Resi9 Combi SPU 1PN C Surge Protection Device

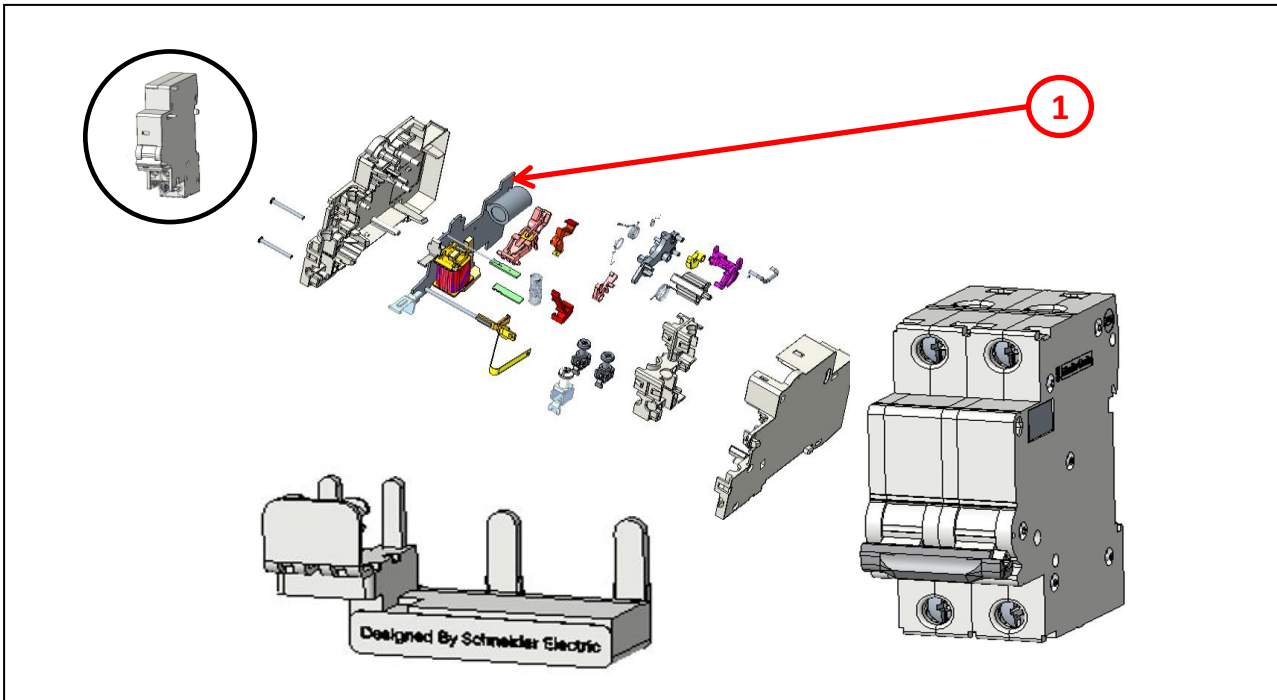

## End of Life Instructions



Recommendation	Number on drawing	Component / Material	Weight (in g)	Comment
To be depolluted	①	Electronic Board	14.7	SPU

## Product description

Manufacturer identification	Schneider Electric Industries SAS
Brand name	Schneider Electric
Product function	<p>The function of Resi9 Combi SPU 1PN C Surge Protection Device is to provide in low voltage power systems:</p> <p>--SPU (Surge transient overvoltages and Power frequency overvoltage protection Unit):</p> <ul style="list-style-type: none"> <li>•Protect during against direct or indirect effects of lightning or against transient overvoltages electrical equipments connected to electrical networks</li> <li>•Detect power frequency overvoltage and trigger MCB and indicate overvoltage fault</li> </ul> <p>--MCB (Miniature Circuit Breaker):</p> <ul style="list-style-type: none"> <li>•Protect the installation against overloads and short-circuits in circuit (with assigned voltage 400 VAC (Ue) and rated current 25A (In)).</li> </ul>
Product reference	R9L20625
Additional similar product references	R9L20625
Total representative product mass	343.4 g
Representative product dimensions	92.35mm x 54mm x 73.3mm
Date of information release	2/2022

## Additional information

### Legal information

This product family is in the scope of European Union directive 2012/19/EU on Waste Electrical and Electronic Equipment (WEEE). The product family must be disposed according to the legislation of the country. This document is intended for use by end of life recyclers or treatment facilities. It provides the basic information to assure an appropriate end of life treatment for the components and materials of the product.

### Recyclability potential

**63%** Based on “ECO’DEEE recyclability and recoverability calculation method” (version V1, 20 Sep. 2008 presented to the French Agency for Environment and Energy Management: ADEME).

Schneider Electric Industries SAS  
 Country Customer Care Center  
<http://www.schneider-electric.com/contact>  
 35, rue Joseph Monier  
 CS 30323  
 F- 92506 Rueil Malmaison Cedex  
 RCS Nanterre 954 503 439  
 Capital social 896 313 776 €

[www.schneider-electric.com](http://www.schneider-electric.com)

Published by Schneider Electric

ENVEOLI2012004\_V1

© 2019 - Schneider Electric – All rights reserved

2/2022