



Optimize your office, empower your employees

EcoStruxure™ Workplace Advisor



schneider-electric.us/wpa

Life Is On

Schneider
Electric

Create a responsive workplace with data and digital experiences

Technology and agile work trends are transforming today's office environments.

New ways of working are increasing demand for innovative and flexible workspaces. To address the challenges of today's dynamic and competitive commercial office landscapes, it's essential to collect and analyze important data. This facilitates quick, objective decision-making that drives efficiency, reduces facility operating expenses, and increases occupant comfort. A comfortable, responsive workplace helps reduce friction in the employee experience, which helps attract and retain the best talent while enhancing their productivity.

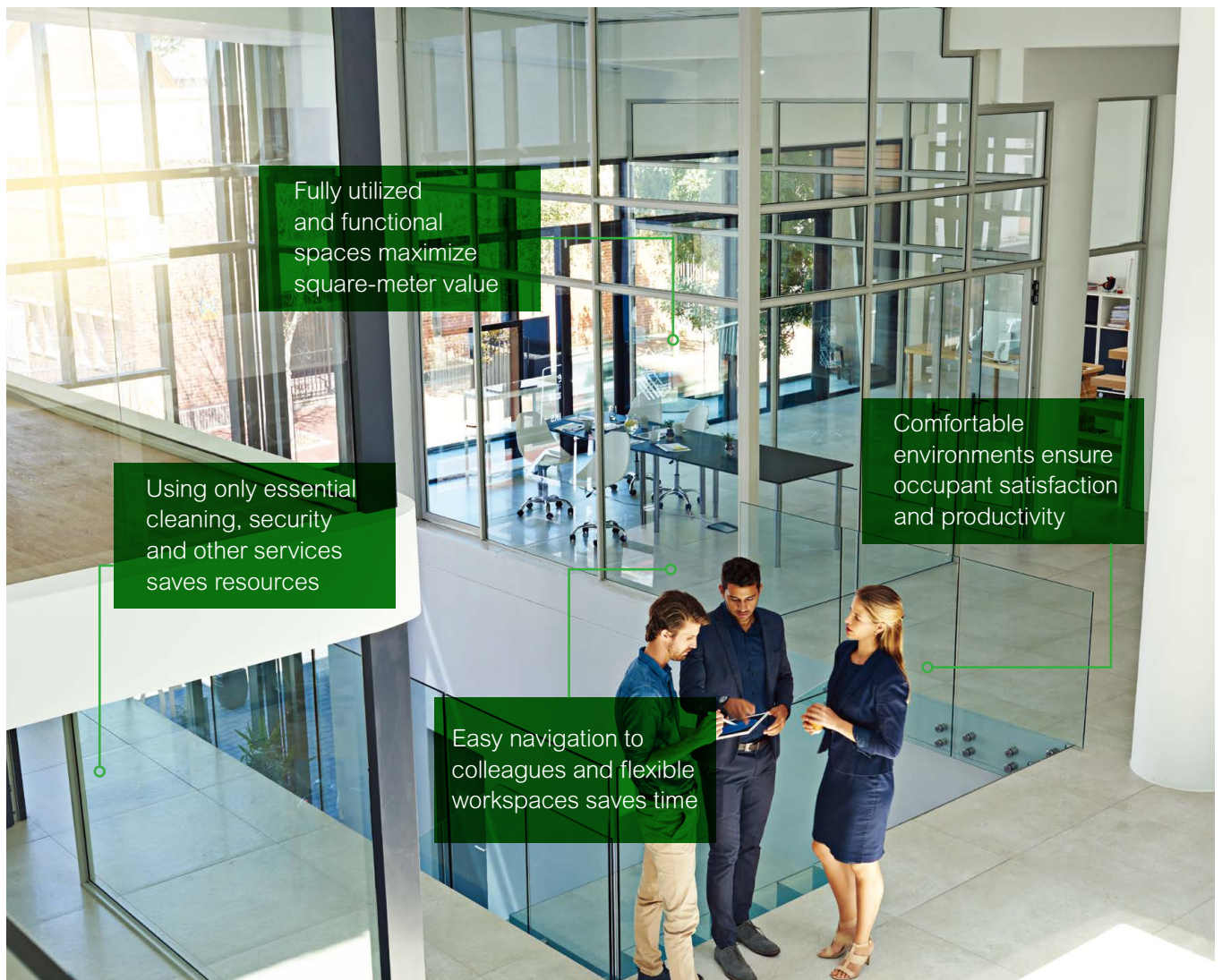

EcoStruxure™ Workplace Advisor

EcoStruxure Workplace Advisor is a suite of digital services for building managers to create smart workplaces that optimize the use of space, improve comfort, enhance productivity, and reduce facility service costs. Users can derive actionable insights through intuitive dashboards that analyze data from Internet of Things (IoT) devices and systems. At the same time, employees can find efficient and convenient ways to connect to their workspaces using mobile applications.



How does this happen? Real-time, high-fidelity data is collected through Schneider Electric or third-party sensors that monitor occupancy and environmental characteristics. This data is analyzed on our secure Microsoft Azure cloud, and the curated analytics are tracked in dashboards and used to make data-driven decisions as well as shared with other systems deployed in the building.

EcoStruxure™ Workplace Advisor



An open, flexible and secure platform that makes new or existing buildings smarter and more comfortable, and occupants more productive.

Maximize space efficiency

Quickly identify underutilized desks, offices, meeting rooms, and amenities for effective reallocation based on real data. Change the layout of flexible vs. fixed desks to align with employee usage and evolving headcount. Let employees see available spaces in real-time to support office hoteling.

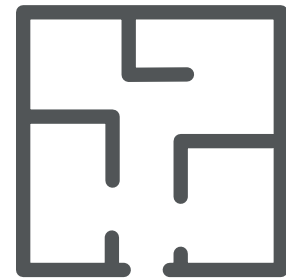

space optimization

Free up valuable space through right-sizing

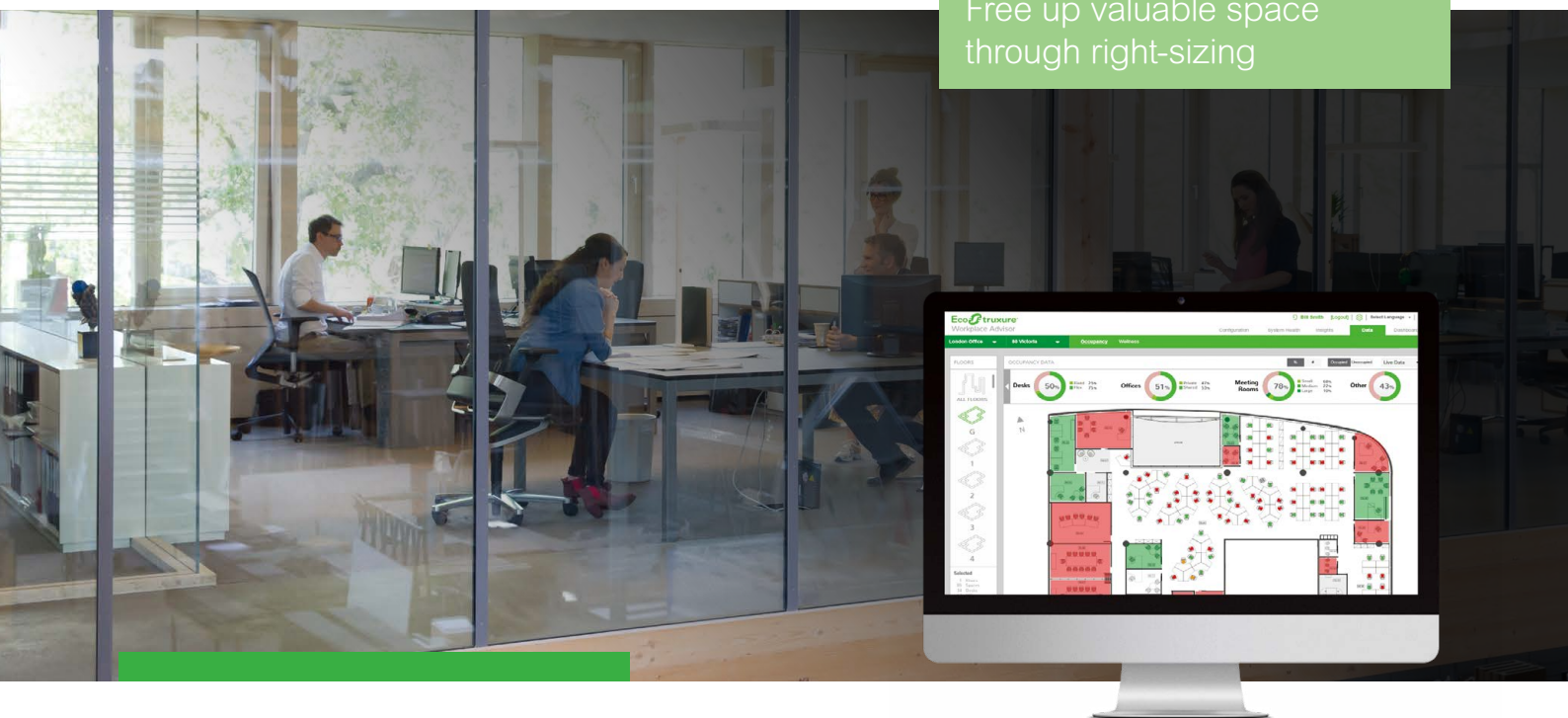

Improve occupant well-being

Enhance the well-being of building occupants and increase their productivity by actively monitoring temperature, humidity, CO₂, noise, light and volatile organic compound (VOC) levels. You can aggregate and rank these conditions with a comfort score and pinpoint issues to improve work environments.

well-being

Improve employee satisfaction and productivity

Improve occupant productivity

Make navigating buildings easy! Help employees save valuable time and avoid frustration with a mobile wayfinding application that quickly provides the location of colleagues, meeting spaces, desks, or amenities. Maintain digital floor plans so they are always up-to-date for anyone searching for a space.



employee
experience

Make the most of every minute

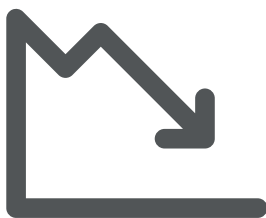

Reduce building operating costs

operational
efficiency

Save on labor and
operational expenses

Optimize facility management services and make operational decisions faster with access to real-time occupancy data and analytics. Adjust and improve lighting and HVAC levels, and cleaning and security services, based on actual space utilization trends.

Why choose EcoStruxure Workplace Advisor

- Obtain data on space usage and well-being for fact-based decision making and reporting
- Reduce employee issue escalations by improving their comfort and workplace experience
- Create a dynamic workplace that enhances your organization's brand and attracts talent

What makes it unique

- A suite of evolving digital services; flexible and easy to deploy and maintain in new or retrofit buildings
- One consolidated window to analyze insights on Occupancy and Well-being today; extend to People Flow and Asset data in the future
- Includes a unique comfort score to pinpoint spaces for attention and maximize occupant well-being
- Developed on an open platform; secure and compliant with stringent IT requirements

Why partner with Schneider Electric

- We are an innovative leader in building operations technologies with a proven track record of delivering smart buildings worldwide
- Our global footprint means we can serve your worldwide portfolio and provide local support wherever you are
- Our solutions are built on EcoStruxure™, an open, interoperable, IoT-enabled system architecture and platform leveraging IoT, mobility, sensing, cloud, analytics and cybersecurity to deliver Innovation at Every Level

Learn more



Discover EcoStruxure



Discover EcoStruxure Building



Learn about Sogeprom



Tour Majunga Tower



Explore The Edge



Contact us to learn more

schneider-electric.us/wpa

Schneider Electric
1650 West Crosby Road
Carrollton, TX 75006

Life Is 

Schneider
 Electric™