

# Product End-of-Life Instructions

## Lexium LXM32 / LXM52 Servo Drive

### Product Range

Lexium LXM32 / LXM52 Servo Drive

### Marketing Model

LXM32●●●●●●, LXM52●●●●●●

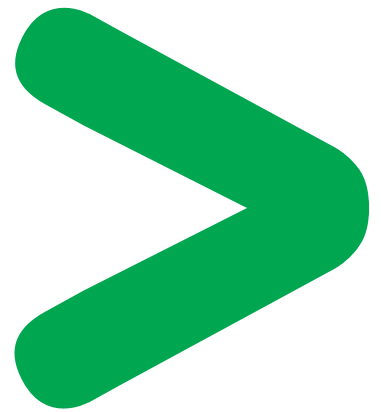

Size in mm (H x L x D):

274 x 225 x 108

Weight in g:

5552



**Schneider**  
Electric

## Operations recommended for the end of life treatment

There are several steps to process the products at the end of life so as to recover components, materials or energy :

Reuse ⇒ Separation for special treatment ⇒ Other Dismantling ⇒ Shredding

**CAUTION: RISK OF ELECTRIC SHOCK DUE TO ELECTRICAL COMPONENTS CONTAINING ENERGY: ELECTROLYTIC CAPACITORS**

The components of the products that optimize the recycling performances are listed, identified and located hereunder.

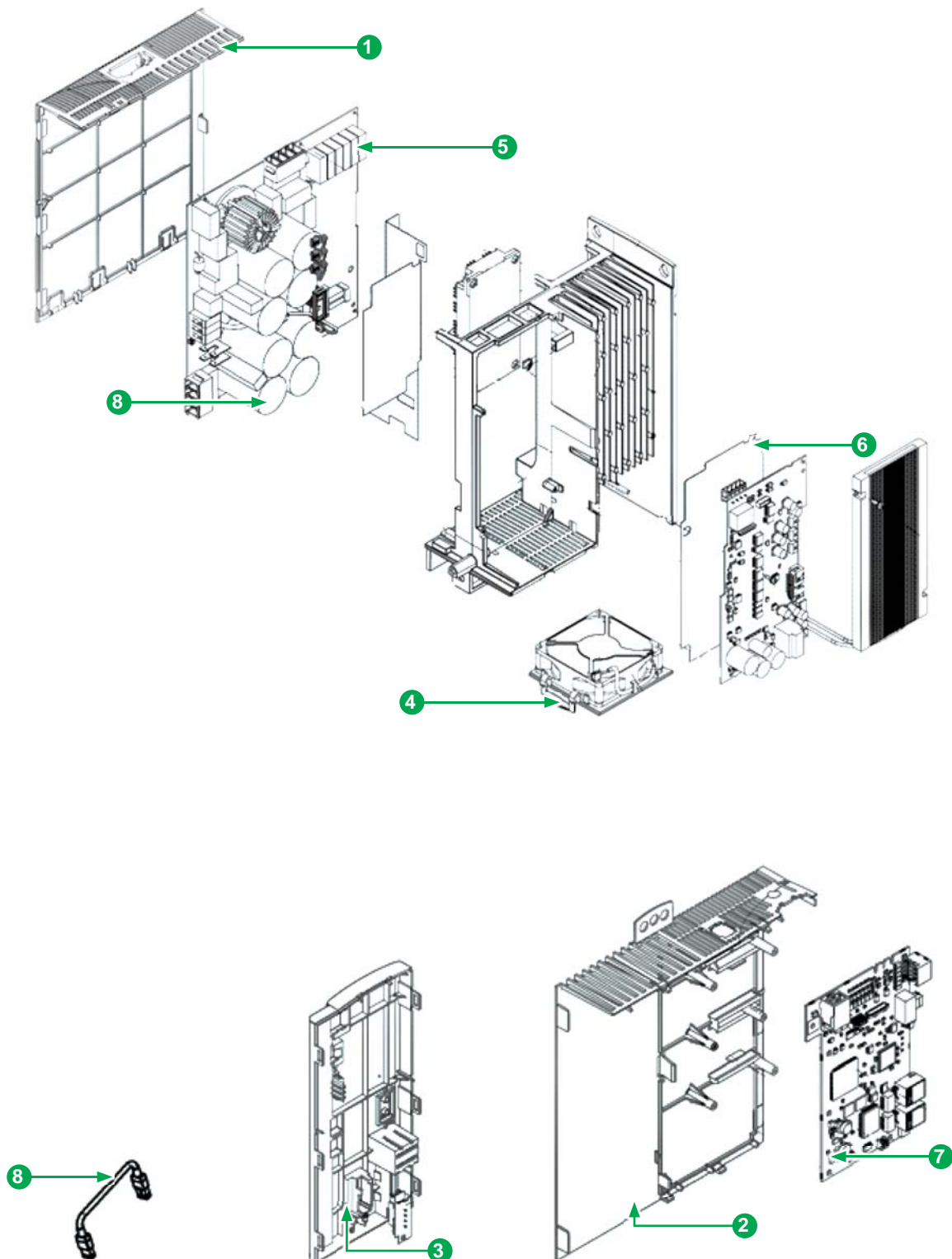

Recommendation	Number on drawing	Components	Weight (g)	Comment
Dismantling	1	Rightside housing	91.20	Polycarbonate
	2	Leftside housing	142.80	Polycarbonate
	3	Front face	99	Polycarbonate
	4	Fan support	14.70	Polycarbonate
Depollution	5	PCBA	1350	–
	6	PCBA	130	–
	7	PCBA	88	–
	8	Cable Serco Bridge	18.70	–
	9	Electrolytic capacitors (8)	80	–

**Schneider Electric Industries SAS**

35, rue Joseph Monier  
CS30323  
F - 92506 Rueil Malmaison Cedex

RCS Nanterre 954 503 439  
Capital social 896 313 776 €  
www.schneider-electric.com

The version of the Guide used to create the document: End of Life Instruction Drafting Guide of Schneider Electric version V3.

Publication : Schneider Electric