

Symmetra PX160 with PDU-XR(Right)

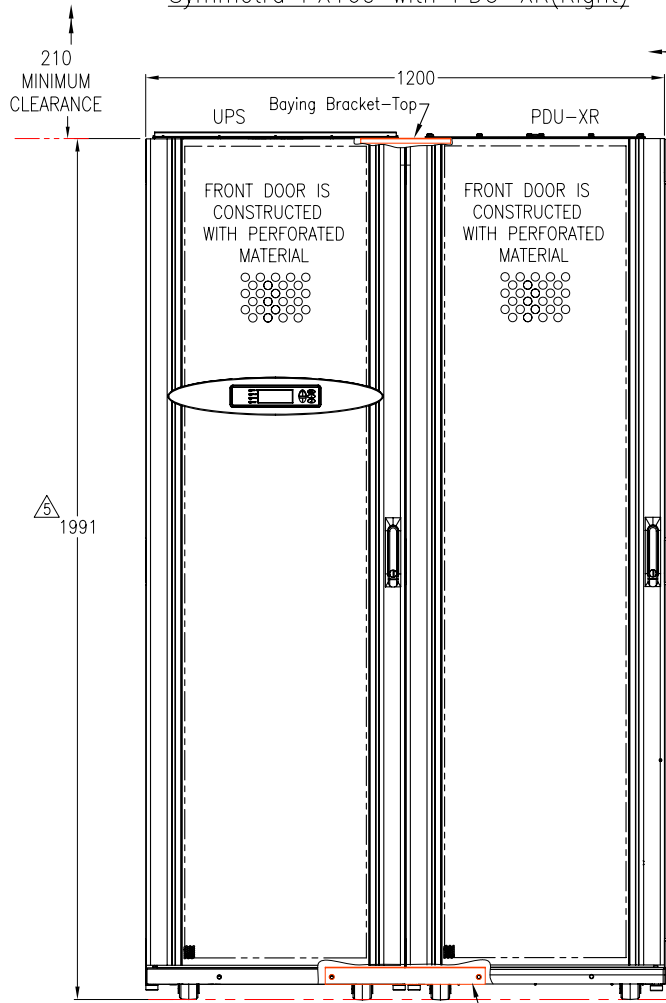

FRONT VIEW

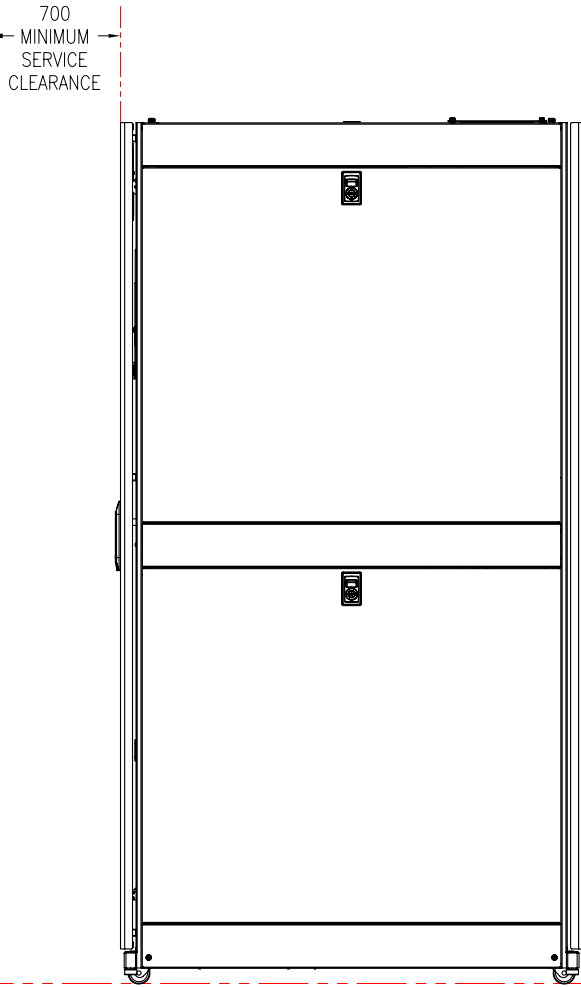

LEFT SIDE VIEW

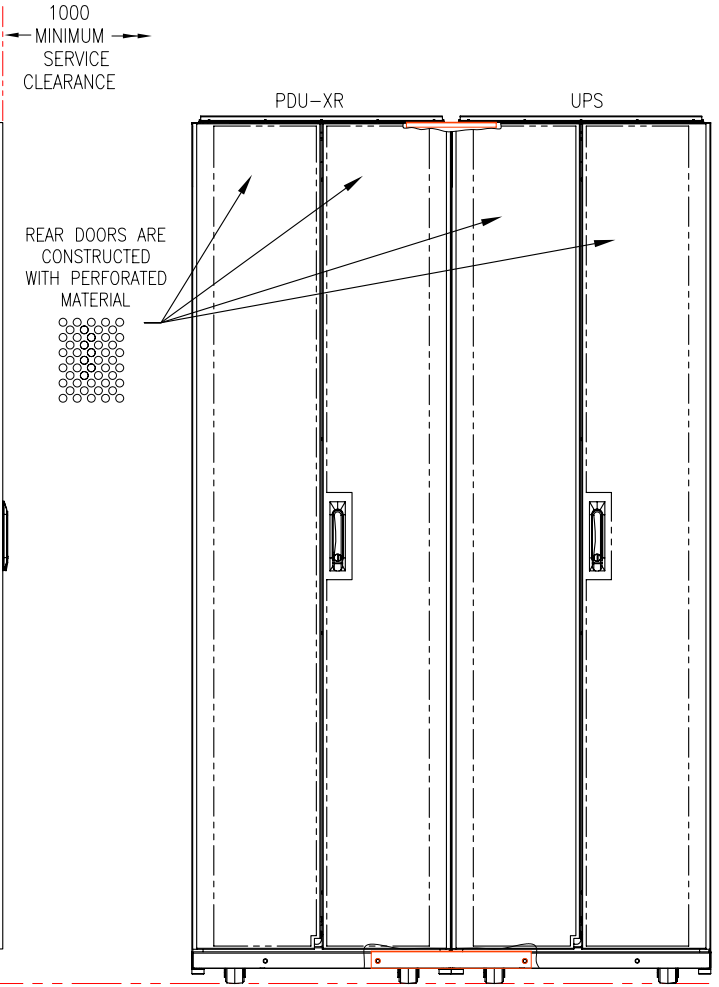

REAR VIEW

Baying Bracket-Bottom
(PDU-XR OR XR TO UPS)

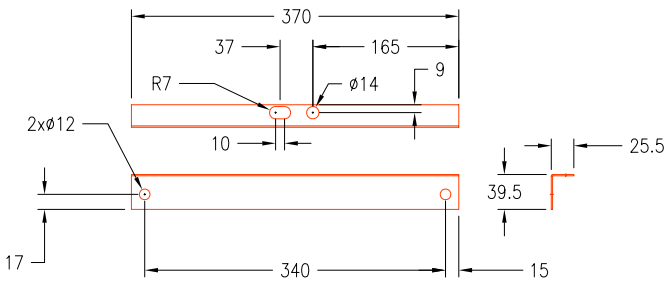

Baying Bracket-Top
(PDU-XR OR XR TO UPS)

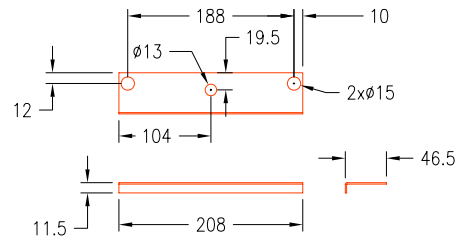

NOTES:

- PLEASE REFER TO APC PRODUCT MANUAL.
- ALL DIMENSIONS ARE IN MILLIMETERS.
- CABLE ENTRY DETAILS: TOP OR BOTTOM OF THE UNIT
- WEIGHT DETAILS :

RATING	32kW	64kW	96kW
WEIGHT	1094 kg	1454 kg	1813 kg
- MAXIMUM HEIGHT OF THE UPS UNIT IS 2011mm AND THE PDU-XR UNIT IS 2004mm (INCLUDES TOP ACCESSORIES, BOLTS AND NUTS THAT ARE MOUNTED ON TOP OF THE UNIT).
- MAXIMUM 4 BATTERY ENCLOSURES MAY BE USED WITH THE SYSTEM. THIS NUMBER INCLUDES PDU-XR
- INSTALLATION MUST COMPLY ALL APPLICABLE NATIONAL AND LOCAL ELECTRICAL REGULATIONS

THIS DRAWING AND SPECIFICATIONS HEREIN ARE THE PROPERTY OF AMERICAN POWER CONVERSION AND SHALL NOT BE COPIED, REPRODUCED OR USED IN WHOLE OR IN PART, AS THE BASIS FOR THE MANUFACTURE OR SALE OF ITEMS WITHOUT WRITTEN PERMISSION FROM APC. THIS DRAWING IS BASED UPON LATEST AVAILABLE INFORMATION AND IS SUBJECT TO CHANGE WITHOUT NOTICE.



TITLE: SYMMETRA PX160
32kW SCALABLE TO 96kW, 400V, 3PH
PDU-XR CABINET WITH
MODULAR DISTRIBUTION
MECHANICAL LAYOUT-1
PROJECT: SUBMITTAL DRAWINGS SHEET 1 OF 5

DWG NO: SY32K96H-PD-MM1
DRAWN: K.NAGENDRA 19-NOV-07
ENGINEER: P.BONDE/S.LEE 04-DEC-07
APPROVED: C.LARSEN/S.WAGH/E.SILVA 04-DEC-07

REV: 0
FIRST ANGLE PROJECTION

Symmetra PX160 with PDU-XR(Left)

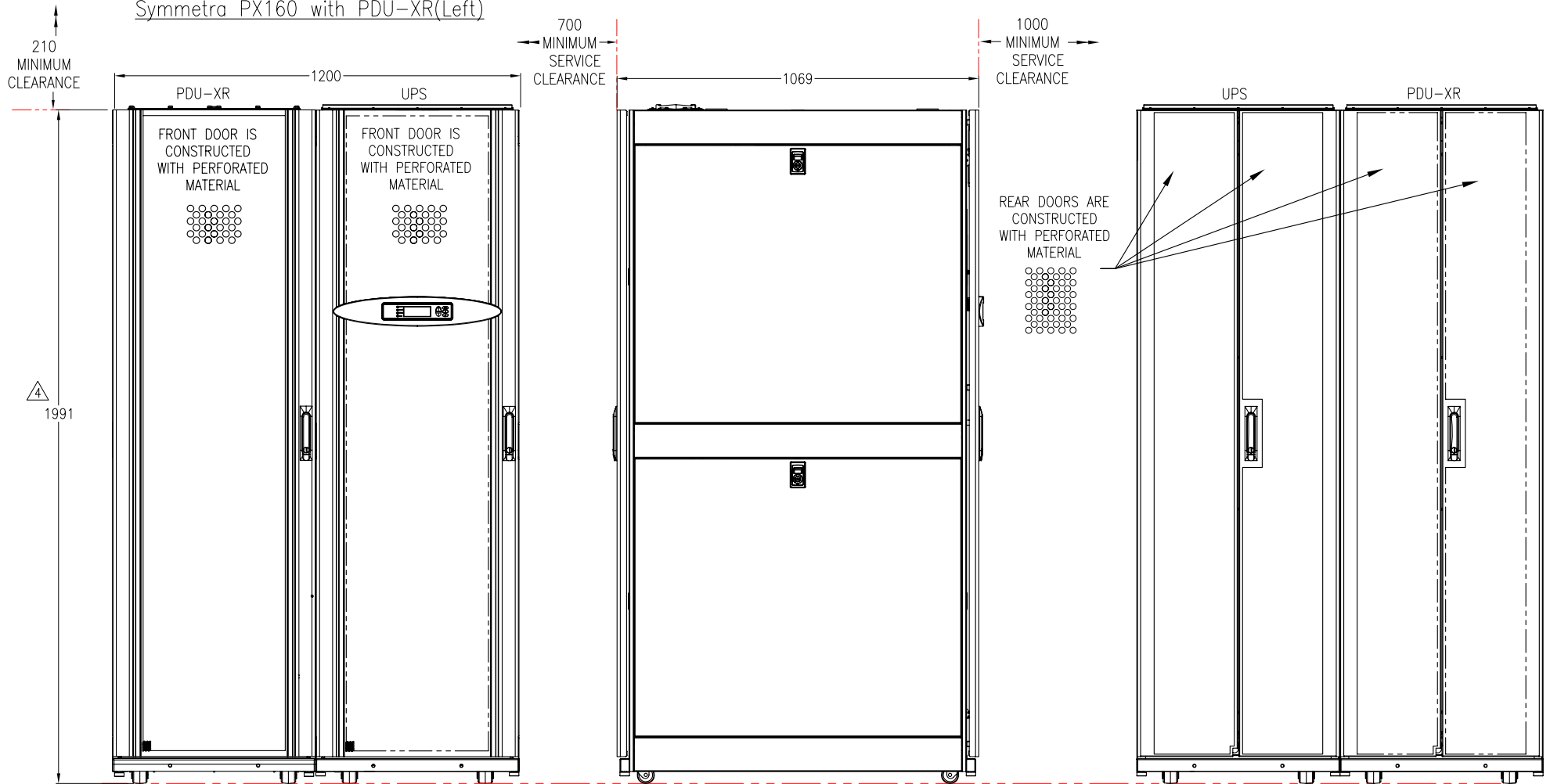

FRONT VIEW

LEFT SIDE VIEW

REAR VIEW

Baying Bracket-Top
(XR TO XR)

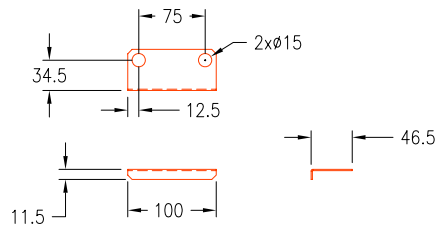

NOTES:

1. PLEASE REFER TO APC PRODUCT MANUAL.
2. ALL DIMENSIONS ARE IN MILLIMETERS.
3. CABLE ENTRY DETAILS:
TOP OR BOTTOM OF THE UNIT
- △ 4. MAXIMUM HEIGHT OF THE UPS UNIT IS 2011mm AND THE PDU-XR UNIT IS 2004mm
(INCLUDES TOP ACCESSORIES, BOLTS AND NUTS THAT ARE MOUNTED ON TOP OF THE UNIT).
5. MAXIMUM 4 BATTERY ENCLOSURES MAY BE USED WITH THE SYSTEM. THIS NUMBER INCLUDES PDU-XR
6. INSTALLATION MUST COMPLY ALL APPLICABLE NATIONAL AND LOCAL ELECTRICAL REGULATIONS

THIS DRAWING AND SPECIFICATIONS HEREIN ARE THE PROPERTY OF AMERICAN POWER CONVERSION AND SHALL NOT BE COPIED, REPRODUCED OR USED IN WHOLE OR IN PART, AS THE BASIS FOR THE MANUFACTURE OR SALE OF ITEMS WITHOUT WRITTEN PERMISSION FROM APC. THIS DRAWING IS BASED UPON LATEST AVAILABLE INFORMATION AND IS SUBJECT TO CHANGE WITHOUT NOTICE.



TITLE: SYMMETRA PX160
32kW SCALABLE TO 96kW, 400V, 3PH
PDU-XR CABINET WITH
MODULAR DISTRIBUTION
MECHANICAL LAYOUT-2

DWG NO: SY32K96H-PD-MM2

DRAWN: K.NAGENDRA 19-NOV-07

ENGINEER: P.BONDE/S.LEE 04-DEC-07

APPROVED: C.LARSEN/S.WAGH/E.SILVA 04-DEC-07

REV. 0

FIRST ANGLE PROJECTION

PROJECT: SUBMITTAL DRAWINGS SHEET 2 OF 5

Symmetra PX160 with PDU-XR(Right)

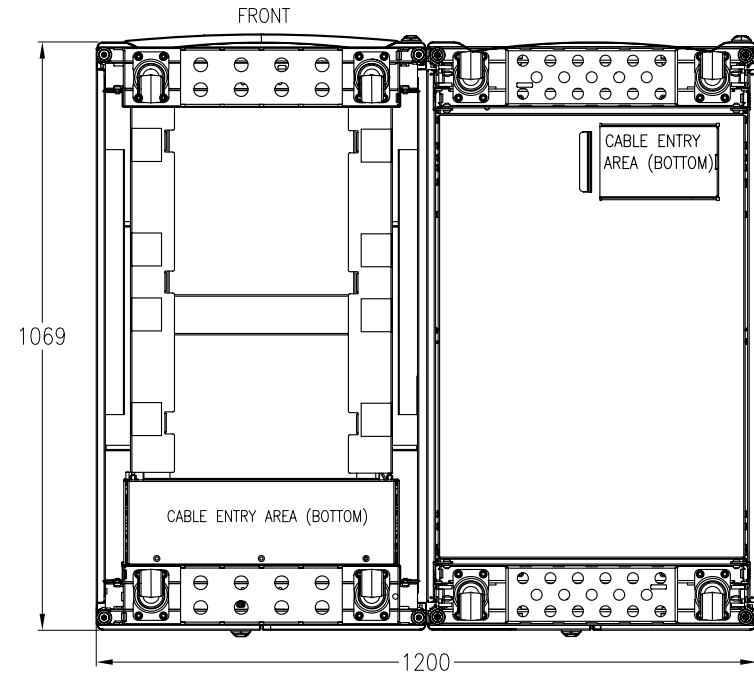
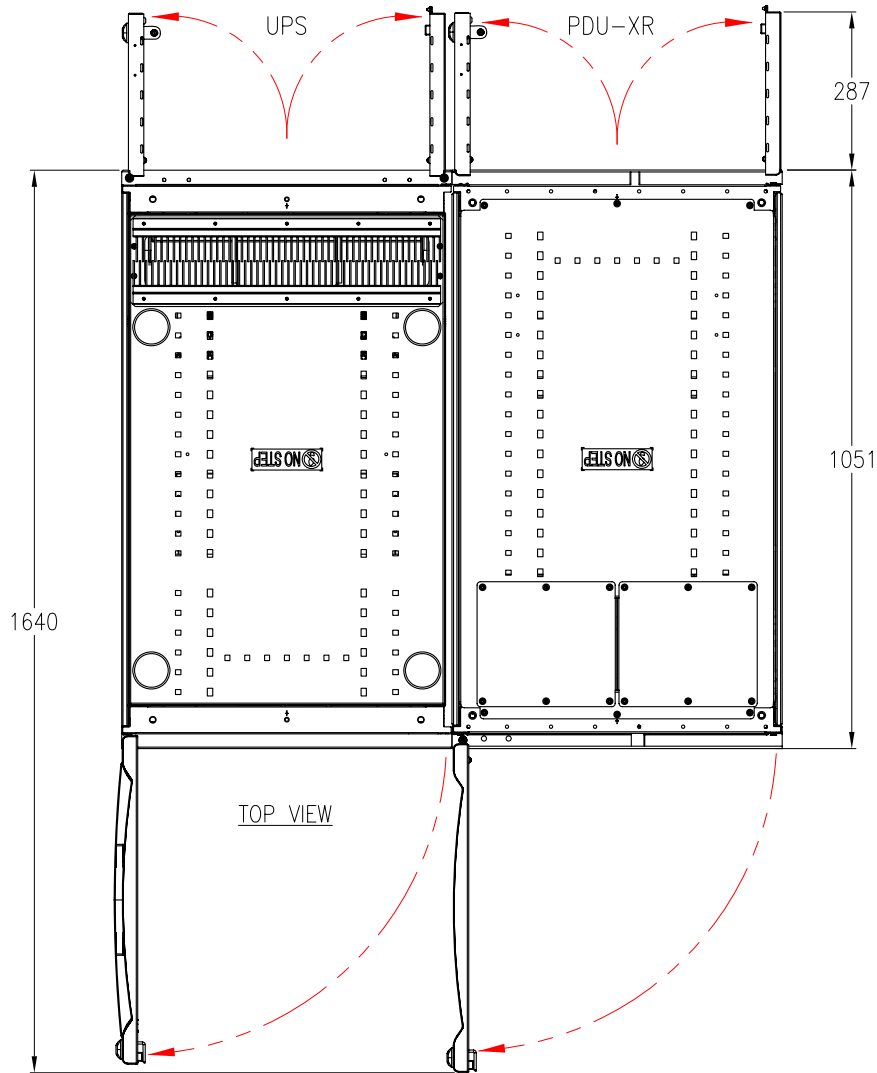

BOTTOM VIEW

NOTES:

1. PLEASE REFER TO APC PRODUCT MANUAL.
2. ALL DIMENSIONS ARE IN MILLIMETERS.
3. FOR TOP OR BOTTOM CABLE ENTRY REMOVE TOP OR BOTTOM CONDUIT PLATE, DRILL OR PUNCH HOLES WITHIN PROVIDED CABLE ENTRY AREA. REFIT COVER AND INSTALL CONDUITS.
4. INSTALLATION MUST COMPLY ALL APPLICABLE NATIONAL AND LOCAL ELECTRICAL REGULATIONS

THIS DRAWING AND SPECIFICATIONS HEREIN ARE THE PROPERTY OF AMERICAN POWER CONVERSION AND SHALL NOT BE COPIED, REPRODUCED OR USED IN WHOLE OR IN PART, AS THE BASIS FOR THE MANUFACTURE OR SALE OF ITEMS WITHOUT WRITTEN PERMISSION FROM APC. THIS DRAWING IS BASED UPON LATEST AVAILABLE INFORMATION AND IS SUBJECT TO CHANGE WITHOUT NOTICE.



TITLE: SYMMETRA PX160
32kW SCALABLE TO 96kW, 400V, 3PH
PDU-XR CABINET WITH
MODULAR DISTRIBUTION
TOP AND BOTTOM VIEW-1

DWG NO: SY32K96H-PD-MM3

REV. 0

DRAWN: K.NAGENDRA 19-NOV-07

ENGINEER: P.BONDE/S.LEE 04-DEC-07

APPROVED: C.LARSEN/S.WAGH/E.SILVA 04-DEC-07

PROJECT: SUBMITTAL DRAWINGS SHEET 3 OF 5

FIRST ANGLE PROJECTION

Symmetra PX160 with PDU-XR(Left)

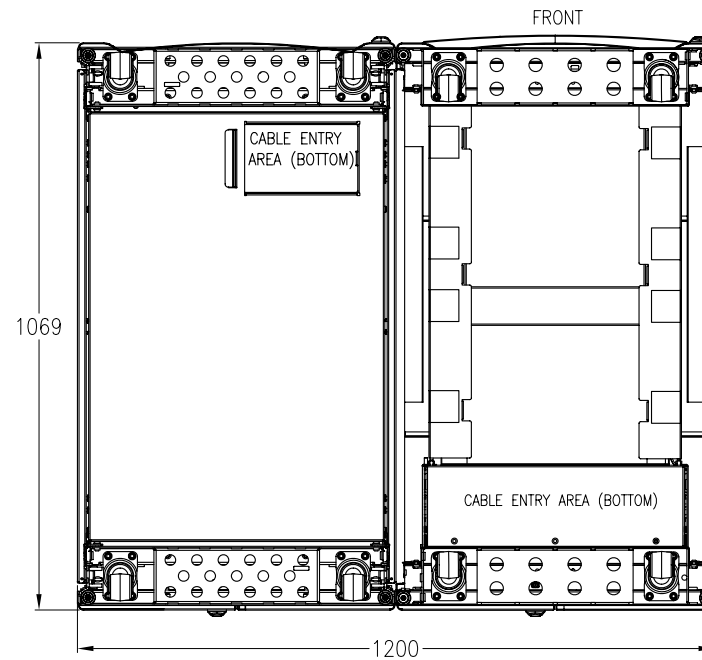
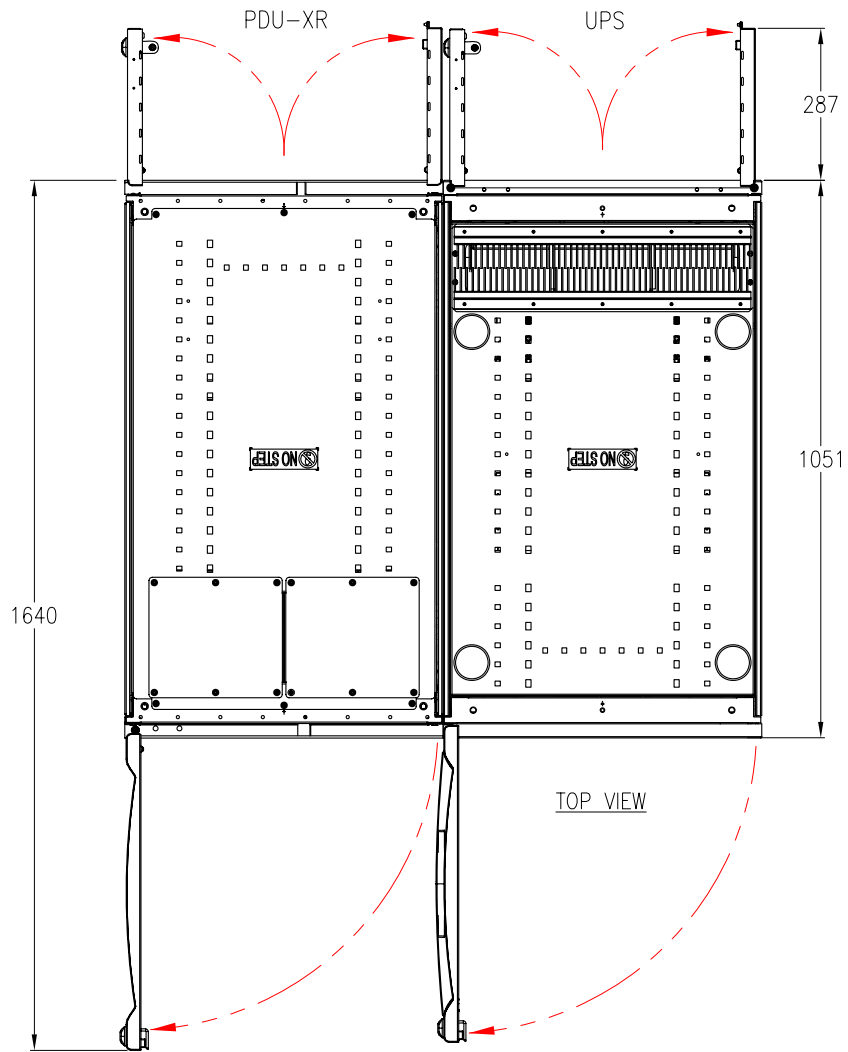

NOTES:

1. PLEASE REFER TO APC PRODUCT MANUAL.
2. ALL DIMENSIONS ARE IN MILLIMETERS.
3. FOR TOP OR BOTTOM CABLE ENTRY REMOVE TOP OR BOTTOM CONDUIT PLATE, DRILL OR PUNCH HOLES WITHIN PROVIDED CABLE ENTRY AREA. REFIT COVER AND INSTALL CONDUITS.
4. INSTALLATION MUST COMPLY ALL APPLICABLE NATIONAL AND LOCAL ELECTRICAL REGULATIONS

THIS DRAWING AND SPECIFICATIONS HEREIN ARE THE PROPERTY OF AMERICAN POWER CONVERSION AND SHALL NOT BE COPIED, REPRODUCED OR USED IN WHOLE OR IN PART, AS THE BASIS FOR THE MANUFACTURE OR SALE OF ITEMS WITHOUT WRITTEN PERMISSION FROM APC. THIS DRAWING IS BASED UPON LATEST AVAILABLE INFORMATION AND IS SUBJECT TO CHANGE WITHOUT NOTICE.



TITLE: SYMMETRA PX160
32kW SCALABLE TO 96kW, 400V, 3PH
PDU-XR CABINET WITH
MODULAR DISTRIBUTION
TOP AND BOTTOM VIEW-2

DWG NO: SY32K96H-PD-MM4

DRAWN: K.NAGENDRA 19-NOV-07

ENGINEER: P.BONDE/S.LEE 04-DEC-07

APPROVED: C.LARSEN/S.WAGH/E.SILVA 04-DEC-07

REV. 0

FIRST ANGLE PROJECTION

COMMUNICATION CABLES IN INSTALLATION
UPS WITH PDU-XR (RIGHT)

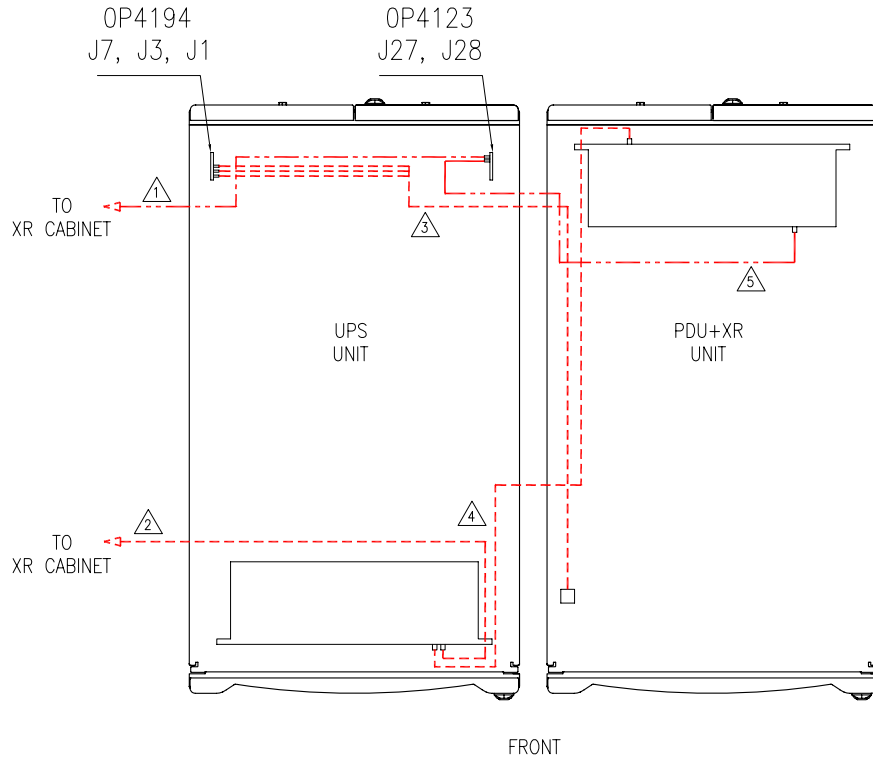

COMMUNICATION CABLES IN INSTALLATION
UPS WITH PDU-XR (LEFT)

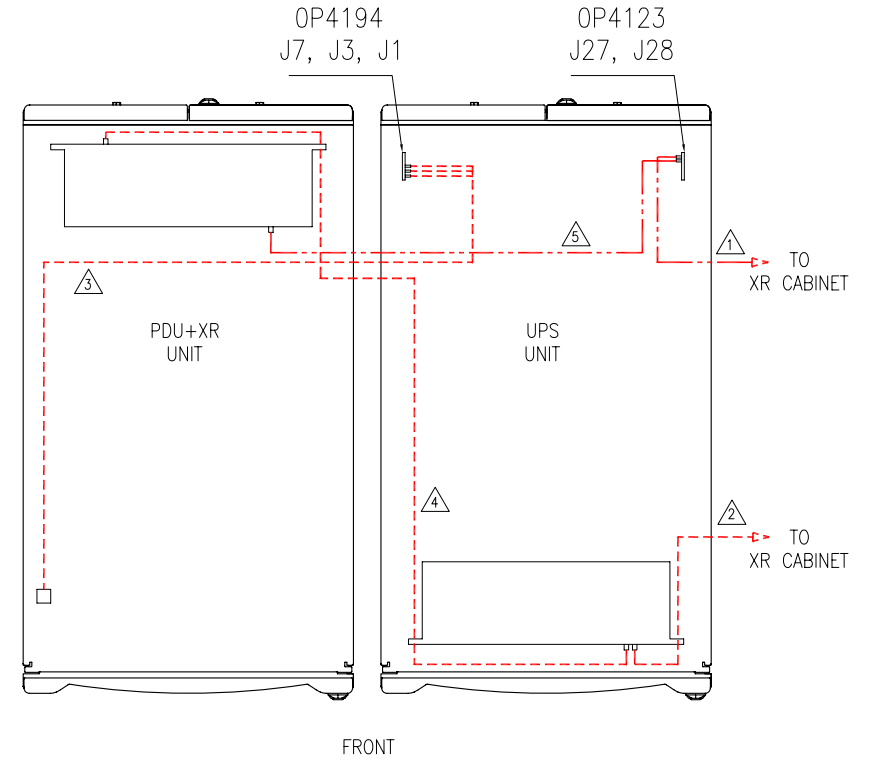

LEGENDS:

----- EPO CONNECTIONS
- - - - - COMMUNICATION CABLES

- ① BATTERY BREAKER TRIP CABLE FROM XR ENCLOSURE TO THE CONNECTOR J27 OF EPO/ANCILLARY INTERFACE BOARD(OP4123).
- ② COMMUNICATION CABLE FROM THE LAST XR BATTERY ENCLOSURE IN THE ROW TO THE UPS I/O PORT 2.
- ③ PDU COMMUNICATION CABLES(3 CABLES) FROM THE PDU-XR ENCLOSRE TO THE CONNECTORS J7, J3, J1 OF MAINTENANCE BYPASS INTERFACE BOARD (OP4194).
- ④ COMMUNICATION CABLE FROM THE PDU-XR TO THE UPS I/O PORT.
- ⑤ BATTERY BREAKER TRIP CABLE FROM THE PDU-XR TO THE CONNECTOR J28 OF EPO/ANCILLARY INTERFACE BOARD(OP4123).

NOTES:

1. PLEASE REFER TO APC PRODUCT MANUAL.
2. INSTALLATION MUST COMPLY ALL APPLICABLE NATIONAL AND LOCAL ELECTRICAL REGULATIONS

THIS DRAWING AND SPECIFICATIONS HEREIN ARE THE PROPERTY OF AMERICAN POWER CONVERSION AND SHALL NOT BE COPIED, REPRODUCED OR USED IN WHOLE OR IN PART, AS THE BASIS FOR THE MANUFACTURE OR SALE OF ITEMS WITHOUT WRITTEN PERMISSION FROM APC. THIS DRAWING IS BASED UPON LATEST AVAILABLE INFORMATION AND IS SUBJECT TO CHANGE WITHOUT NOTICE.



TITLE: SYMMETRA PX160
32kW SCALABLE TO 96kW, 400V, 3PH
PDU-XR CABINET WITH
MODULAR DISTRIBUTION
WIRING DETAILS

PROJECT: SUBMITTAL DRAWINGS SHEET 5 OF 5

DWG NO: SY32K96H-PD-ME1

DRAWN: K.NAGENDRA	19-NOV-07	REV. 0
ENGINEER: P.BONDE/S.LEE	04-DEC-07	FIRST ANGLE PROJECTION
APPROVED: C.LARSEN/S.WAGH/E.SILVA	04-DEC-07	