

2 AND 3-POLE DEFINITE PURPOSE - 600
VAC, 50-60 HZ

FULL LOAD AMPERES CODE (2)	
TYPE	FLA
12 (2 POLE)	20 FLA
13 (3 POLE)	
22 (2 POLE)	25 FLA
23 (3 POLE)	
32 (2 POLE)	30 FLA
33 (3 POLE)	
42 (2 POLE)	40 FLA *
43 (3 POLE)	

ELECTRICAL CLEARANCE/WIRE
BENDING SPACE

MINIMUM TO WALL OR BARRIER TO INSURE ADEQUATE
WIRE BENDING SPACE TO LUG SURFACE WHEN THE
MAXIMUM WIRE SIZE IS USED. REF. NEC 430-10

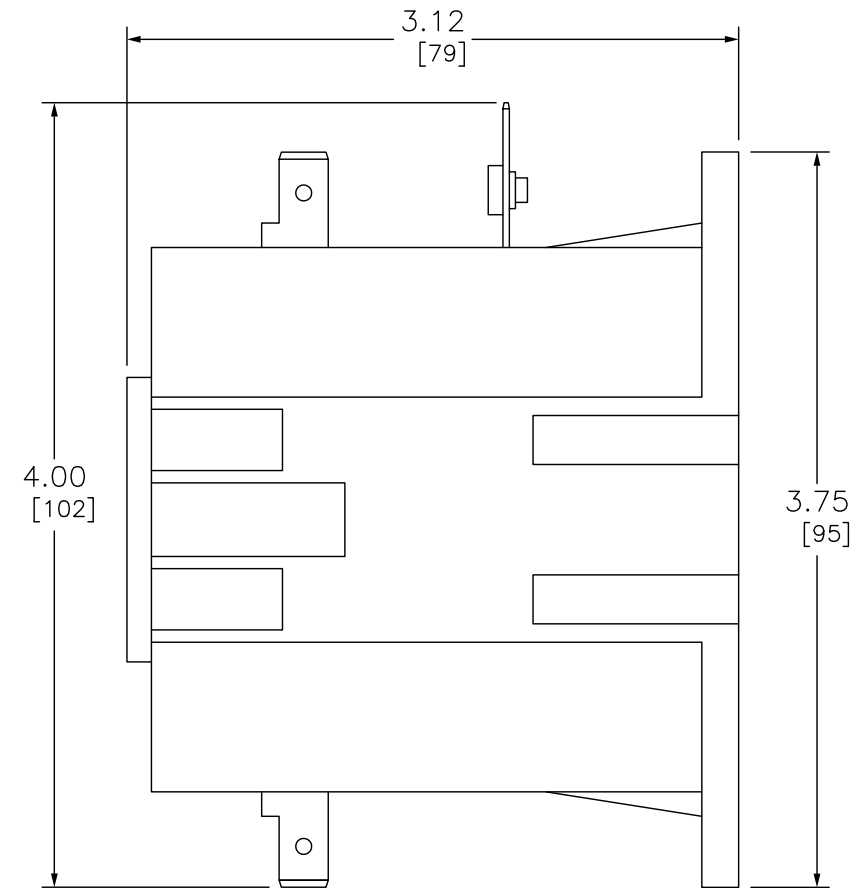
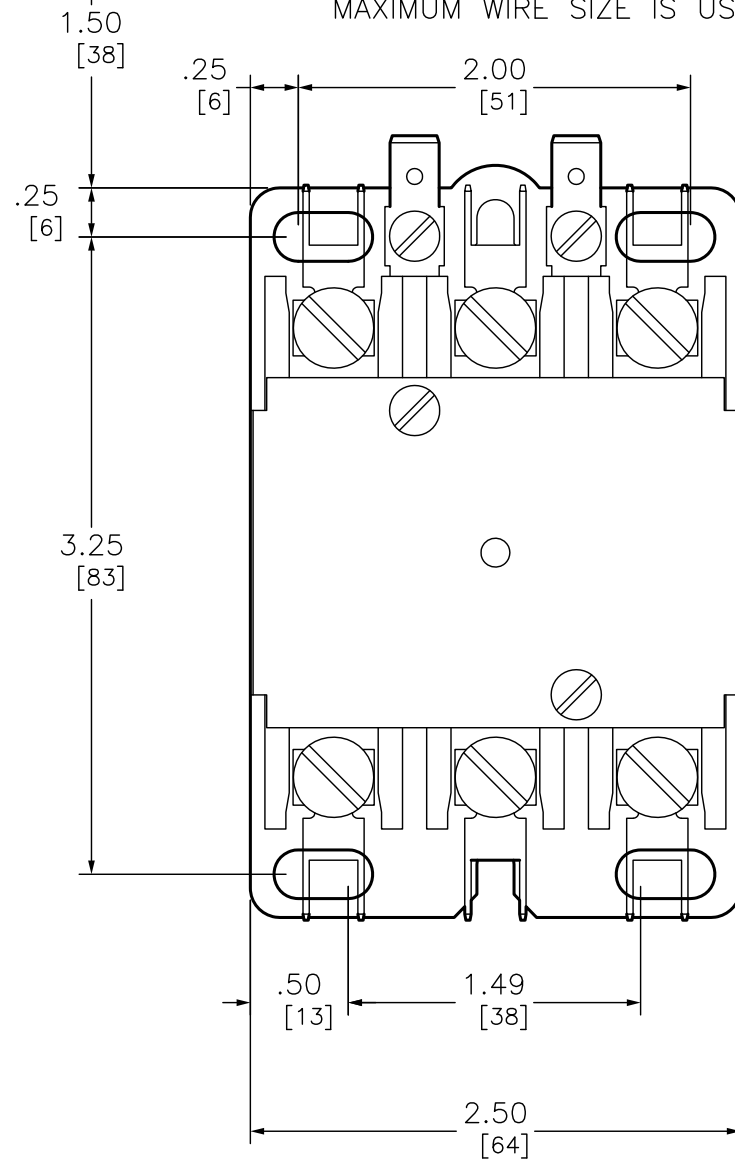

COIL VOLTAGE CODE (1)	VOLTAGE	
	60 HZ	50 HZ
V14	24	24
V02	120	110
V09	208-240	220
V04	277	-
V06	480	440
V07	600	550

QUICK CONNECT TERMINALS AND
BINDER HEAD SCREWS FOR EASY
WIRING.

* = BOX LUGS #14-#6 AWG
WIRE SIZE

Catalog Number: 8910-DPA(2)(1)
Ratings: SEE CHART
UL File/CCN: E42240/CCN NLDX
CSA File/Class: LR25490/321104
Meets Standards: -
Weight: 1.22 LB
Wire Size: POWER -#14-#8
Terminal torque: 18lb - in (20 to 30 FLA) 25lb - in (40 FLA)
Mounting Hwd.: (4) #10 or M5 screws

DUAL DIMENSIONS: INCHES
MILLIMETERS

CONTACTOR 600VAC 30AMP DPA + OPTIONS



DWG# 8910DPA33V09Y125Y234Y239
NO.