

| KNOCKOUTS | | | | | | |
|-----------|-----|-----|------|------|------|------|
| SYMBOL | A | B | D | E | F | G |
| IN | .50 | .75 | 1.25 | 1.50 | 2.00 | 2.50 |
| NM | 13 | 19 | 32 | 38 | 51 | 64 |

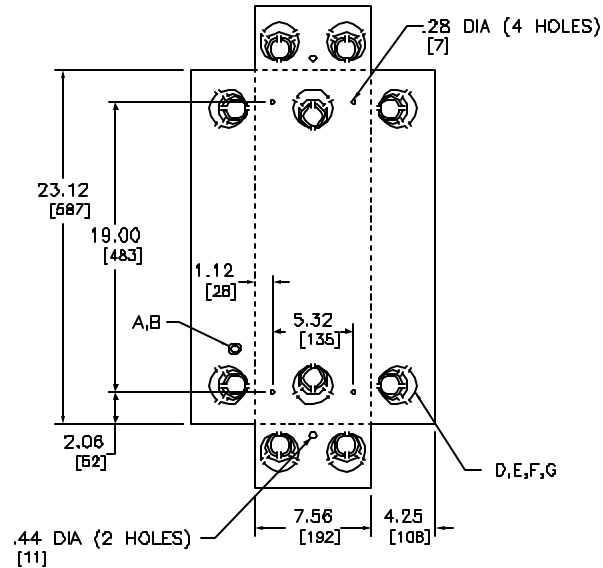

DUAL DIMENSIONS: INCHES
MILLIMETERS

| SERVICE | AMPERE RATING | GENERAL PURPOSE NEMA TYPE 1 | CIRCUIT BREAKER (ORDER SEPARATELY) | | | NEUTRAL ASSEMBLY TERMINAL LUG WIRE SIZE AWG | |
|---------|---------------|-----------------------------|------------------------------------|--|----------------------------------|---|--------------------------|
| | | | CATALOG NUMBER | UL LISTED INTERRUPTING RATING RMS SYM. AMPERES | TERMINAL LUG WIRE SIZE AWG AL/CU | NEUTRAL TERMINALS | GROUNDING TERMINALS ▲ |
| | 100-200A | Q2-22DONS | Q2L | 10,000 | # 4-30D | #4-250 AL/CU | #12-1/0 AL OR #14-1/0 CU |
| | 70-225A | | Q2L-H | 22,000 | | | |
| | | | QBL | 10,000 | | | |
| | | | QDL | 25,000 | | | |
| | | | QCL | 65,000 | | | |
| | | | QVL | 100,000 | | | |

NOTES:
FINISH - GRAY BAKED ENAMEL ELECTRODEPOSITED OVER CLEANED PHOSPHATIZED STEEL.
UL LISTED - FILE E-136861
NEUTRALS - INSULATED GROUNDABLE.
▲ EQUIPMENT GROUND KIT FACTORY INSTALLED.

QO LOAD CENTERS
GENERAL PURPOSE ENCLOSURE
ENCLOSED CIRCUIT BREAKER DEVICES

SQUARE D COMPANY

DWG# 3046
NO.