

Product End-of-Life Instructions

**ALTIVAR PROCESS –
Low Harmonic Drive Systems
Ranges:
90 to 800kW - 400V- 3PH – IP23/IP54**

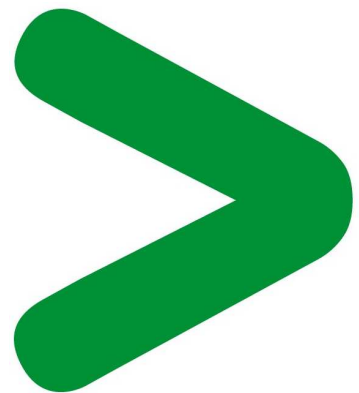

Schneider
Electric

Product End-of-Life Instructions – EoLI

Product overview

Product Range: This range consists of products with ratings from 90 to 800 kW for operation on 400V, 3-phase supplies, IP23/IP54.

Marketing Model/Name: Altivar 680 315kW / 400V / 3-ph supply / IP54 (ref. ATV680C31Q4X1)

Size: W x H x D in mm = **1000 x 2350 x 664**

Weight: From 445000 g to 2045000 g for the product range.

Weight is 803000 g for ATV680C31Q4X1 including packaging and batteries (weight of the battery is 3 g).

Purpose

The product family must be disposed according to the legislation of the country. This document is intended for use by end of life recyclers or treatment facilities. It provides the basic information to assure an appropriate end of life treatment for the components and materials of the product.

Operations recommended for the end of life treatment

There are several steps to process the products at the end of life so as to recover components, materials or energy :

Reuse → Separation for special treatment → Other dismantling → Shredding

CAUTION: This product contains electrolytic capacitors which may cause electrical shock during the end of life treatment process. BEFORE SERVICING, REMOVE ALL POWER, **WAIT 15 MINUTES**.

Product End-of-Life Instructions – EoLI

The components of the products that optimize the recycling performances are listed, identified and located hereunder.

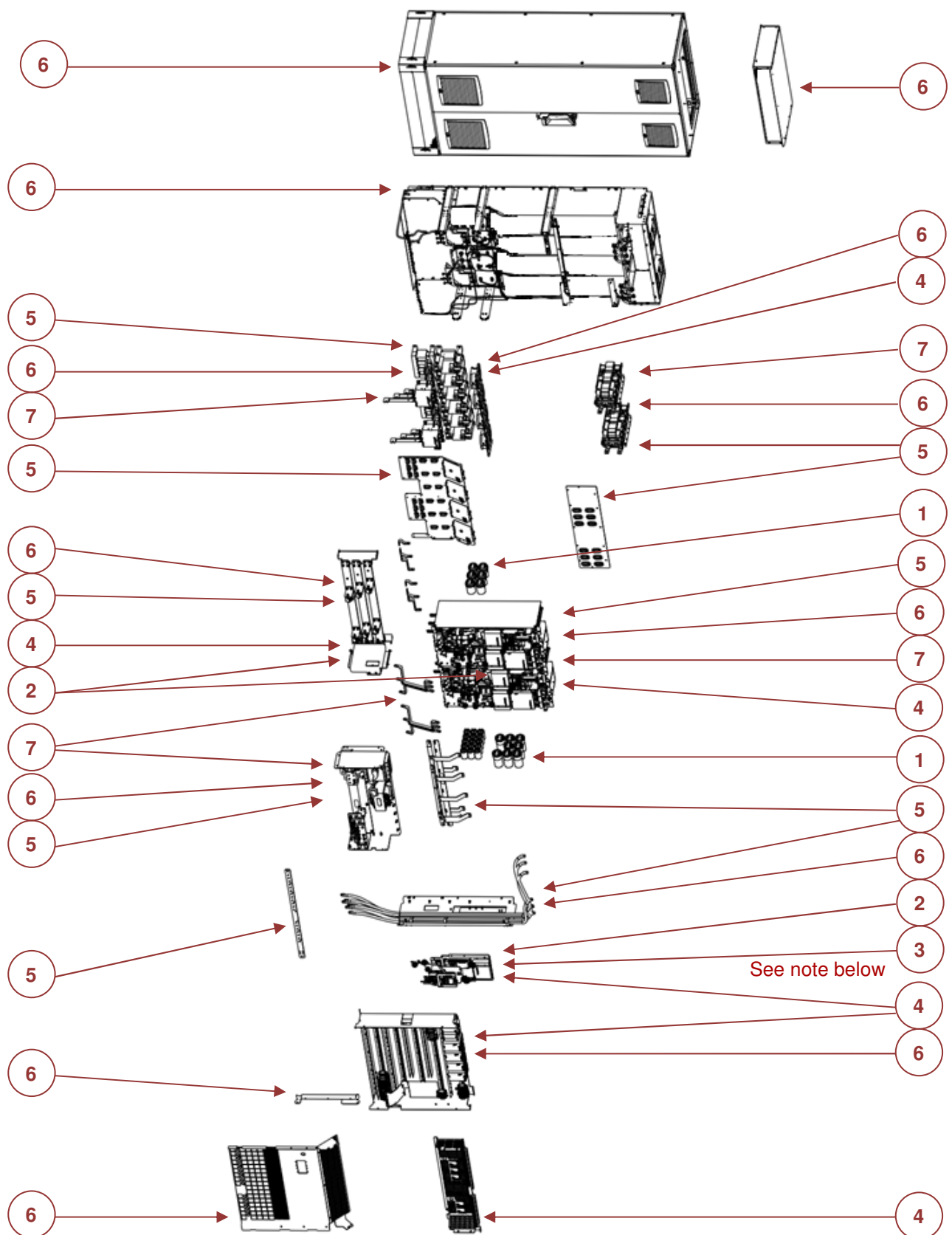

Product End-of-Life Instructions – EoLI

Note:

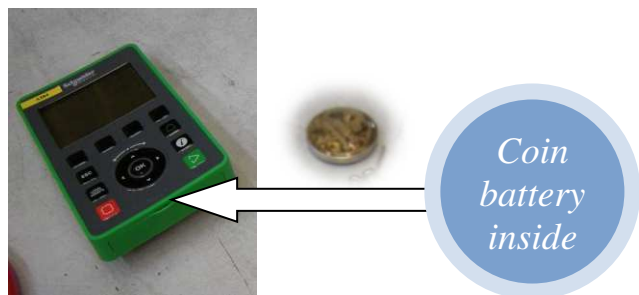

Recommendation	Number on drawing	Components	Weight (in g)	Comment
Operating hazards	1	Electrolytic capacitors	15628	28 pieces are included
Special treatment	2	Printed Circuit Board Assembly (PCBA) or power components	6290	26 PCBAs are included
	3	Manganese Dioxide Lithium Coin Battery	3	The battery is located inside the Keypad
Other dismantling	4	Plastic part	10664	
	5	Aluminium	112085	
	6	Steel	521831	
	7	Copper	44374	

Schneider Electric Industries SAS

35, rue Joseph Monier
CS 30323
F- 92506 Rueil Malmaison Cedex
RCS Nanterre 954 503 439
Capital social 896 313 776 €

www.schneider-electric.com